

## The Fifty-Fifth Meeting of the Southwestern Psychological Association

President

**Lauren Scharff**

Stephen F. Austin State University / USAFA

Past President

**Linda S. Hynan**

U.T. Southwestern Medical Center

President-Elect

**Scott Bailey**

Texas Lutheran University

### Executive Council Members

Arkansas

**James A Gillaspy, Jr**

University of Central  
Arkansas

Kansas

**Arnold Froese**

Sterling College

Louisiana

**Larry Dilks**

McNeese State University

Missouri

**Frances (Dee) Montgomery**

Missouri University of  
Science & Technology

Oklahoma

**Brett Roark**

Oklahoma Baptist  
University

Tennessee

**Dana K Fuller**

Middle Tennessee  
State

Texas

**Marilyn A. Pugh**

Texas Wesleyan  
University

Secretary-Treasurer

**Sharon Roberts**

Northeastern State University

### Association and Convention Support Staff

Convention Manager

**Loretta Neal McGregor**

Arkansas State University

Program Chair

**Jeanne P. Burdsal**

Wichita State University

Historian

**James A Gillaspy, Jr**

University of Central Arkansas

Election Commissioner

**Charles Burdsal**

Wichita State University

## Presidents of the Southwestern Psychological Association

Gardner Murphy, PhD, 1954  
Aaron Q Sartain, PhD, 1956  
Gordon V Anderson, PhD, 1957  
Robert R Blake, PhD, 1958  
Wayne H Holtzman, PhD, 1959  
Ruth M Hubbard, PhD, 1960  
Fillmore Sanford, PhD, 1961  
John P Anderson, PhD, 1962  
Saul B Sells, PhD, 1963  
Irwin A Berg, PhD, 1964  
Ira Iscoe, PhD, 1965  
Benjamin Fruchter, PhD, 1966  
Malcolm D Arnoult, PhD, 1967  
Jackson B Reid, PhD, 1968  
Daniel E Sheer, PhD, 1969  
Oscar A Parsons, PhD, 1970  
Janet T Spence, PhD, 1971  
James Leslie McCary, PhD, 1972  
Frank A Logan, PhD, 1973  
Vladimir Pishkin, PhD, 1974  
Logan Wright, PhD, 1975  
Harry J Parker, PhD, 1976  
C Eugene Walker, PhD, 1977  
Henry C Ellis, PhD, 1978  
Alvin G Burstein, PhD, 1979  
H Wayne Ludvigson, PhD, 1980  
June Gallessich, PhD, 1981  
Roger L Mellgren, PhD, 1982  
Toni Falbo, PhD, 1983  
Larry Christenson, PhD, 1984  
Douglas P Ferraro, PhD, 1985  
Warren H Jones, PhD, 1986  
Janet R Matthews, PhD, 1987  
Stephen F Davis, PhD, 1988  
Clyde Hendrick, PhD, 1989  
Francis T Durson, PhD, 1990  
Randolph A Smith, PhD, 1991  
Robert L Montgomery, PhD, 1992  
Gordon K Hodge, PhD, 1993  
Dennis C Cogan, PhD, 1994  
Michael R Best, PhD, 1995  
Roger E Kirk, PhD, 1996  
Robert T Hogan, PhD, 1997  
Vicki Green, PhD, 1998  
Jesse E Purdy, PhD, 1999  
Theresa A Wozencraft, PhD, 2000  
Randall Wight, PhD, 2001  
John M Davis, PhD, 2002  
Mary Brazier, PhD, 2003  
Kenneth M Weaver, PhD, 2004  
Edward P Kardas, PhD, 2005  
Paul R Nail, PhD, 2006  
Charles A Burdsal, PhD, 2007  
Linda S Hynan, PhD, 2008  
Lauren Scharff, PhD 2009

### SWPA Social Topic Table Facilitators

Many thanks to the following individuals who have agreed to serve as facilitators at topic tables at our SWPA Social on Thursday, April 2<sup>nd</sup>.

Dr. Richard Beck (Personality)	Abilene Christian University
Dr. Michael Czuchry (S&P)	Texas Lutheran University
Dr. Helen Just (Health)	Saint Edwards University
Dr. Marilyn Pugh (Social)	Texas Wesleyan University
Dr. Drew Terranova (Developmental)	Stephen F. Austin State U.
Dr. Kenneth Weaver (Cognitive)	Emporia State University
Dr. Jennifer Welbourne (I/O)	UT – Pan American
Dr. Theresa Wozencraft (Counseling)	University of Louisiana- Lafayette

### SWPA *Student Lunch with a Psychologist* Facilitators

Many thanks to the following individuals who agreed to lead table discussions at our APA sponsored: *Student Lunch with a Psychologist* on Friday, April 3<sup>rd</sup>.

Dr. Chrisanne Christensen	Southern Arkansas University
Dr. Steve Davis	Morningside College
Dr. Sam Gosling	University of Texas – Austin
Dr. Ernest Jouriles	Southern Methodist University
Dr. Marilyn McGinnis	UT Health Science Center - SA

## From the President

**Lauren Scharff**

*Stephen F. Austin State University*

Welcome! After a year of planning and much hard work by the executive committee and staff (many thanks!), here we are in San Antonio for the **55<sup>th</sup> Annual SWPA Convention**. I believe we have a fantastic program for you that will expand our understanding of human and animal behavior, research and statistical methods, and the teaching of psychology. We are happy that we have several adjunct organizations again joining the convention and increasing the breadth of our program: SCPA, SAMR, Psi Chi, CTUP, and TPA.

In addition to the research-oriented components of the program, we have built in many opportunities for all of us to visit with friends, meet new colleagues, and network. I know I always leave SWPA somewhat exhausted from all the activities but also invigorated by the new things I have learned and excited to have had conversations with friends old and new.

If you have feedback for me or any of the SWPA Executive Committee members about the convention, our new quarterly newsletters, or anything else that we are doing, please let us know. We want to keep growing in positive directions, and we value your input.

Enjoy the convention!

## 2009 Program Reviewers

Many thanks to our members who served as reviewers!

Brandon Paul Arnold  
Lori Arnold  
Athena Jean Arthur  
Scott A Bailey  
Carl Bartling  
Richard A Beck  
Robert L. Benefield  
Grant Benham  
Luciane Berg  
Stefanie Boswell  
Robert L Boughner  
Anthony E. Bourgeois  
Pamela Brouillard  
Jay C Brown  
Jeanne P. Burdsal  
Jennifer Byrd-Craven  
David L Carlston  
Kim Case  
Shawn R Charlton  
William G. Collier  
Michael D Coon  
Gary F Coulton  
Thomas R Coyle  
Kristin L. Croyle  
Michael L. Czuchry  
Maria Czyzewska  
Donald W. Daughtry  
John M. Davis  
Michael A. Dawes  
Amy Dicke-Bohmann  
Lawrence S Dilks  
Dorothy A. Flannagan  
Arnold D Froese

Art Gillaspy  
Reiko Graham  
Cathy A. Grover  
Brenda Hannon  
Christian L. Hart  
Tracy B Henley  
Keith Hudson  
Linda S Hynan  
Peter E Jaberg  
Matthew C. Johnson  
Robert D. Johnson  
Theodore D Joseph  
Dirk Wilhelm Kadyk  
Shelia M Kennison  
Anselm Khoo  
Bill J. Lammers  
Jeff Lawley  
Veronica E. Lewis  
Lisa K. Lockhart  
Robyn E. Long  
Stella G Lopez  
Don Lucas  
Lani Lyman-Henley  
Pamelyn M  
MacDonald  
William G Masten  
Dena Matzenbacher  
Ralph J. McKenna  
Jo A Meier-Marquis  
Glenn E. Meyer  
Arden T Miller  
D. Wayne Mitchell  
Jo A. Mitchell

Frances Haemmerlie  
Montgomery  
Robert L Montgomery  
Yvonne K. Montgomery  
Paul R. Nail  
Shirley M. Ogletree  
Katherine L Pang  
Scott Perkins  
Cyndra A Pilkington  
Ruth A Provost  
Paul A. Rhoads  
Bret Roark  
Harold Rodinsky  
Darrin L Rogers  
Todd Ryska  
Lauren Scharff  
Carl W. Scott  
Michael J. Serra  
Sangeeta Singg  
Billy L Smith  
Jane Graves Smith  
Theodore Scott Smith  
Ken Sobel  
Laura C Spiller  
Cynthia Turk  
Michael Vandehey  
Sara Villanueva-Dixon  
Jennifer L Welbourne  
Josephine Welsh  
MaryLou Fair Worthen  
Theresa A. Wozencraft  
Victoria Zascavage

## **State Representative Invited Speaker Symposia**

New this year, SWPA has instituted a special set of symposia coordinated by our elected state representatives during the second year of their two-year terms. The state representatives organized their symposia by inviting faculty and other esteemed professionals from around the region and the nation. The intent of these symposia is to further enhance the level of research presented at our annual convention.

### **Acknowledgements**

SWPA gratefully acknowledges the generosity of the Science Directorate of the American Psychological Association for the underwriting of the SWPA's *Lunch with a Psychologist* Program. We also gratefully acknowledge the generosity of the Science Education of the American Psychological Association for their contributions toward the SWPA Social event and underwriting of the Harry Kirke Wolfe Lecture.

### **Audio-Visual Policy**

SWPA will provide computer, projector, and screen for the Invited speakers presenting in the Crystal Ballroom. SWPA will provide a screen and electrical power cords in all other meeting rooms where members present papers, workshops, or symposia. If members need any other audio-visual equipment, they are responsible for making their own arrangements and payment.

The security and storage of any equipment brought to the meeting site is the sole responsibility of the individual bringing or renting the equipment for the meeting. SWPA is not responsible for the security and storage of equipment brought to the meeting site by private arrangement.

### Sheraton Gunter Hotel Meeting Facilities

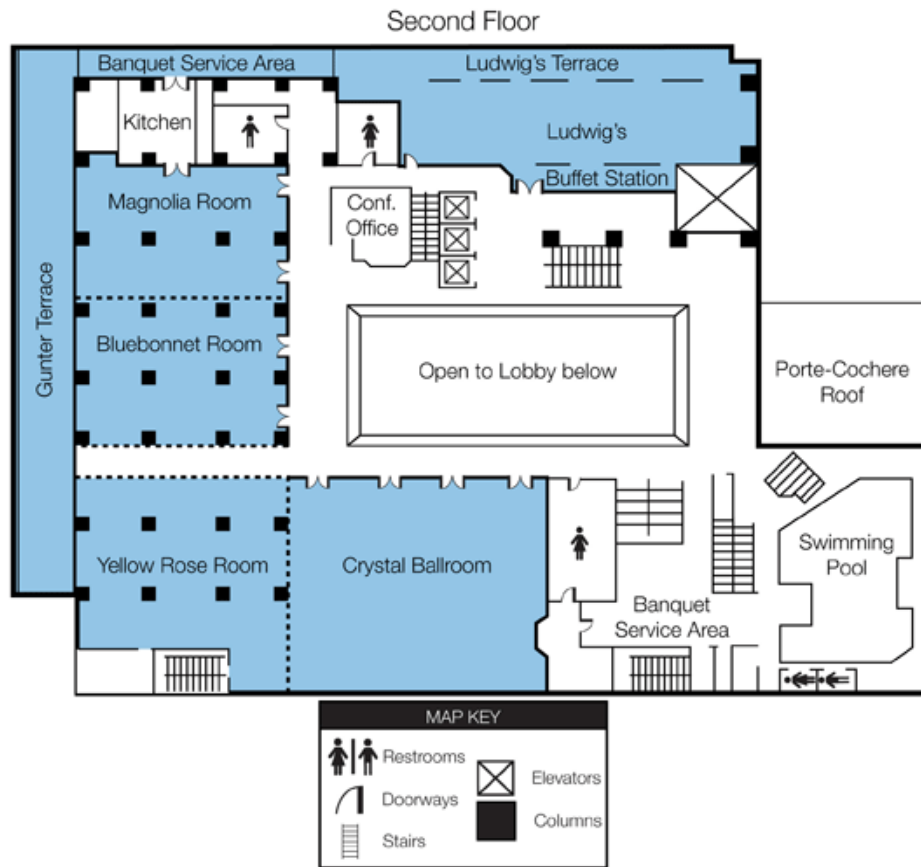

The registration desk will be located on the second floor in the open space outside the Bluebonnet Room. All posters will be in the Gunter Terrace. All CE sessions will be in the Yellow Rose Room. All vendors and department displays will be in the Bluebonnet Room. The Social on Thursday night will be in Ludwig's.

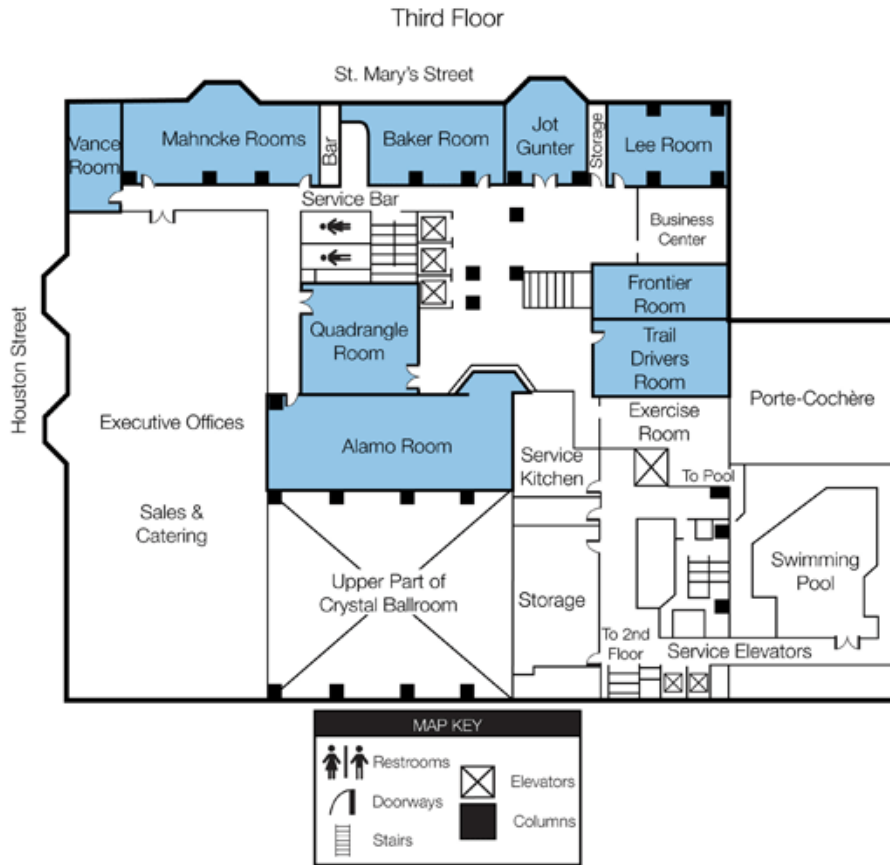

The Psi Chi Hospitality Suite will be located in the Frontier Room.