

The Fiftieth Meeting of the
Southwestern Psychological Association

President

Kenneth A. Weaver

Emporia State University

Past President

Mary Brazier

Loyola University-New Orleans

President-Elect

Edward P. Kardas

Southern Arkansas University

Secretary-Treasurer

Raymond Russin

Kansas Wesleyan University

Executive Council Members

Arizona

Bill Gibson

Northern Arizona University

Arkansas

Bill J. Lammers

University of Central Arkansas

Kansas

Arnold Froese

Sterling College

Louisiana

Mukul Bhalla

Loyola University-New Orleans

Missouri

Robert Montgomery

University of Missouri-Rolla

New Mexico

Gordon K. Hodge

University of New Mexico

Oklahoma

Paul R. Nail

Southwest Oklahoma State

Tennessee

W. Beryl West

Middle Tennessee State

Texas

Scott Bailey

Texas Lutheran University

Association and Convention Support Staff

Convention Manager and Historian

Robert W. Newby

Tarleton State University

Program Chair

Loretta Neal McGregor

Ouachita Baptist University

Publications Manager

Cathy Grover

Emporia State University

Continuing Education

Theresa A. Wozencraft

University of Louisiana-Lafayette

Presidents of the Southwestern Psychological Association

Gardner Murphy, Ph.D., 1954	H. Wayne Ludvigson, Ph.D., 1980
Aaron Q. Sartain, Ph.D., 1956	June Gallessich, Ph.D., 1981
Gordon V. Anderson, Ph.D., 1957	Roger L. Mellgren, Ph.D., 1982
Robert R. Blake, Ph.D., 1958	Toni Falbo, Ph.D., 1983
Wayne H. Holtzman, Ph.D., 1959	Larry Christenson, Ph.D., 1984
Ruth M. Hubbard, Ph.D., 1960	Douglas P. Ferraro, Ph.D., 1985
Fillmore Sanford, Ph.D., 1961	Warren H. Jones, Ph.D., 1986
John P. Anderson, Ph.D., 1962	Janet R. Matthews, Ph.D., 1987
Saul B. Sells, Ph.D., 1963	Stephen F. Davis, Ph.D., 1988
Irwin A. Berg, Ph.D., 1964	Clyde Hendrick, Ph.D., 1989
Ira Iscoe, Ph.D., 1965	Francis T. Durso, Ph.D., 1990
Benjamin Frucheter, Ph.D., 1966	Randolph A. Smith, Ph.D., 1991
Malcolm D. Arnoult, Ph.D., 1967	Robert L. Montgomery, Ph.D., 1992
Jackson B. Reid., Ph.D., 1968	Gordon K. Hodge, Ph.D., 1993
Daniel E. Sheer, Ph.D., 1969	Dennis C. Cogan, Ph.D., 1994
Oscar A. Parsons, Ph.D., 1970	Michael R. Best, Ph.D., 1995
Janet T. Spence, Ph.D., 1971	Roger E. Kirk, Ph.D., 1996
James Leslie McCrary, Ph.D., 1972	Robert T. Hogan, Ph.D., 1997
Frank A. Logan, Ph.D., 1973	Vicki Green, Ph.D., 1998
Valdimir Pishkin, Ph.D., 1974	Jesse E. Purdy, Ph.D., 1999
Logan Wright, Ph.D., 1975	Theresa A. Wozencraft, Ph.D., 2000
Harry J. Parker, Ph.D., 1976	Randall D. Wight, Ph.D., 2001
C. Eugene Walker, Ph.D., 1977	John M. Davis, Ph.D., 2002
Henry C. Ellis, Ph.D., 1978	Mary Brazier, Ph.D., 2003
Alvin G. Burstein, Ph.D., 1979	

Table of Contents

APA/SWPA Undergraduate/Graduate Student Workshop Invitation	1
SWPA and Psi Chi: An Enduring Partnership	2
From the Program Chair	3
Acknowledgements	4
Hotel Information and Transportation	5
Driving Directions	6
Registration	7
Continuing Education Workshop Information	8
Meeting Facilities Layout	9-10
SWPA Executive Council Meeting	11
Index	56
<u>Saul B. Sells Lecture</u>	
Norman Anderson	14
<u>Invited Addresses</u>	
Southwestern Psychological Association (SWPA)	
Rolando Diaz-Loving	18
Gordon Hodge	26
Robert Sternberg	38
Joshua Aronson	47
Ludy T. Benjamin, Jr.	51
Diane Halpern	54
Southwest Comparative Psychological Association (SCPA)	
Daniel D. Moriarty	20
Patrick W. Moore	26
A.M. Prestrude	42
Sheree Watson	45

Invited Addresses

Society for Applied Multivariate Research (SAMR) and SWPA C.R.Snyder	24
Psi Chi Jesse E. Purdy	44
Council of Undergraduate Psychology Programs (CUPP) Maureen McCarthy	30
Council of Teachers of Undergraduate Psychology (CTUP) Lauren Scharff	44
American Psychological Association (APA) John Gabrieli	41
SWPA and SCPA Dave Force	54
<u>SWPA Invited Symposia</u>	
The Psychology of Hate and Terrorism	29
Looking Backwards, Looking Forward, Taking Stock: A Session on the History of SWPA 34	
Best Practices for Teaching Introductory Statistics	43
<u>Symposia</u>	
Religion-Mental Health	11
Partner Abuse	18
Gender and Academe	18
Research and Practice	19
Social Psychology	20
Cognition and Emotion	23
Behavioral Measures of Impulsivity	25
Effects of Ethnicity	28

Symposia

Teaching General Psychology	28
Teaching Evaluations	31
Gender and Ethnicity	31
Laboratory Behavioral Measures of Impulsivity	35
Current Issues in Becoming a Counseling Director	36
Clinical Research and Practice	41
Writing Research Papers	43
Freud	45
Qualitative Research	48
Teaching Social Psychology	52

Paper Sessions**Southwestern Psychological Association (SWPA)**

Human Factor and Industrial/Organizational	20
Culture, Ethnicity, and Gender Issues	24
Cognitive	28
General	36
Social and Developmental	37
Experimental and Learning	44

Southwestern Comparative Psychological Association (SCPA)

Paper Session I	15
Paper Session II	24
Paper Session III	35

Society for Applied Multivariate Research (SAMR)

Paper Session	27
---------------	----

Psi Chi

Paper Session I	30
Psi Chi Paper Session II	38

Research Competitions

SWPA Undergraduate Research Competition	19
SWPA Graduate Research Competition	23

Poster Sessions**Southwestern Psychological Association (SWPA)**

Social and Personality Poster Session I	16
Developmental Poster Session	25
Social and Personality Poster Session II	31
Human Factors, Industrial/Organizational and Computer Technology Poster Session	36
Gender, Culture, and Ethnicity Poster Session	39
Clinical and Counseling Poster Session	42
Behavioral Science Poster Session	45
Cognition, Memory, and Learning Poster Session	49
General Poster Session	52

SCPA and SWPA	28
----------------------	----

CTUP and CUPP

Teaching and Department Activities Poster Session	21
---	----

Psi Chi	11
----------------	----

Attention Aspiring Academics! Attend an Undergraduate/Graduate Student Workshop: A Primer on Entering the Professoriate

A workshop sponsored by the American Psychological Association in conjunction with the Southwestern Psychological Association entitled, "Entering the Academic Marketplace: Advice from Experts," will be held during the convention from 2:00 to 4:00 on Thursday, April 8. This workshop is designed for aspiring academics who are currently undergraduate, graduate, or postdoctoral students. Five questions and others regarding the professoriate will be discussed. Expert panelists will share their insights, with plenty of opportunity for discussion.

Five Important Questions of the Professoriate

1. What are the major rewards and challenges of an academic career?
2. Did graduate school prepare you for the job you are doing now?
3. If you could go back and do one thing differently along your career path, what would it be?
4. What are the biggest "turn ons" and "turn offs" about job candidates who are applying to your department?
5. What do you think the major changes in academic life will be in the coming years?

This workshop is free to students, but an e-mail indicating your intent to attend must be sent to Deborah McCall at dmccall@apa.org.

SWPA and Psi Chi: An Enduring Partnership

This year's meeting celebrates both the 50th anniversary of SWPA and the 75th anniversary of Psi Chi. In recognition of these milestones, and in recognition of the strong relationship between SWPA and Psi Chi throughout SWPA's history, SWPA has chosen to use Psi Chi's colors--blue and gold--for the 2004 program and name badges. As you thumb through the program, glance at colleagues' badges, and enjoy this historic event, be sure to let the colors remind you of the shared goals of the two organizations.

SWPA has always been a very inclusive association, welcoming students to membership and to its conventions. Many of these students are also members of Psi Chi. As academic psychologists our primary products are psychological knowledge and new psychologists. Both SWPA and Psi Chi exist to facilitate the development and dissemination of new knowledge and to nurture the growth and success of future psychologists.

In recent years the link between the two organizations has become even stronger. SWPA Presidents Steve Davis and Jesse Purdy have also served as national presidents of Psi Chi. Also, SWPA has become even more student-friendly and placed more emphasis on promulgation of scientific research. Thus, students are encouraged to present their research in papers or posters and also to compete for research awards in both SWPA and Psi Chi competitions.

As we celebrate the 50th and 75th anniversaries, let's keep in mind the significance of the close association between SWPA and Psi Chi.

John M. Davis
Professor, Texas State University-San Marcos
President, Southwestern Psychological Association, 2001-2002
Vice-President Southwest Region, Psi Chi, the National Honor Society in Psychology, 1999-2004

From the Program Chair
Loretta Neal McGregor
Ouachita Baptist University

Welcome to the 50th Anniversary meeting of the Southwestern Psychological Association. As I pondered what to write, I thought about the words “tradition” and “change.” Many individuals view these terms as polar opposites. They do not believe that tradition and change can co-exist. However, I am not one of those individuals. I believe that tradition and change are both necessary for a strong, successful, and productive life. This not only applies to individuals but to organizations as well. SWPA embraces both “tradition” and “change.” SWPA has established a strong tradition of commitment to Psychology in the Southwest Region of the United States. SWPA has helped shaped psychology at the regional level through strong leadership and networking among its members and at the national level through strong representation and involvement in APA and APS. Additionally, the leaders and members of SWPA also know that growth requires progress and progress is fueled by change. SWPA was one of the first regional psychology associations to develop and use online submission procedures for its annual conference. SWPA understands the necessity of both “tradition” and “change.”

As we celebrate this milestone anniversary, let us pay homage to those individuals who helped to start such a strong tradition of psychology in the Southwest. Additionally, let us encourage those who will one day help change the face of psychology in the Southwest, the nation, and the world. I attended my first SWPA meeting during my sophomore year in college. Since then, I have watched the association and the meeting evolve. I have grown to appreciate this organization, as it has contributed to my professional development in countless ways. I hope to continue the tradition of nurturing those students who attend the meeting and to help them enter the world of professional

psychology. This will be my contribution to the strong tradition established by my predecessors. I will also continue to work and support the growth of this organization so that many other students, including my daughter who is now a member, will have an opportunity to enter and influence the world of psychology.

In closing, I must thank those individuals who provided mentoring, guidance, and support throughout this virginal process. Thanks to Charles Hennig (SCPA), Jeanne Burdsal and Dennis Jackson (SAMR), Heidi Ziemer (CTUP), and John Davis (Psi Chi), for arranging and coordinating your respective conference agendas. I appreciate your flexibility. Ken Weaver, I am so grateful for your wisdom, understanding nature, and work ethic. You are truly an inspiration! I am grateful that this experience has allowed our friendship to blossom. Cathy Grover, thank you for the role that you played in putting together this program. I truly could not have done it without you. To Danny Stewart, thank you for the late night technical support and your prompt email replies. You are a life-saver! To my dear friend Edward Peter Kardas, I cannot even begin to express my gratitude to you. You have been there with me "through thick and thin." Your willingness to assist me on this project was simply another example of your true friendship. Randy Smith, although you were miles away, you still assisted me in many ways, some, you are probably not aware. To Randall Wight, thank you for your continued encouragement. Finally to my dear children Porsha and Sean McGregor, thank you sharing your mom with "psychology," once more.

Acknowledgements

SWPA gratefully acknowledges the generosity of the Science Directorate of the American Psychological Association for its underwriting of the Distinguished Scientist Lecture.

Thank you to the following individuals who served as reviewers.

Scott A. Bailey	Shelia M. Kennison
Carl Bartling	Mark A. Krause
Grant Benham	Lawrence B. Lewis
Mukul Bhalla	Ralph J. McKenna
Elson M. Bihm	Mary Ellen McNaughton-Cassill
Pamela Brouillard	Jo A. Meier
Stephen R. Burgess	Sandra Merryman
Gary F. Coulton	Robert Mowrer
Thomas M. Dougherty	Michael D. Murphy
Ann R. Eisenberg	Paul R. Nail
Laurence A. French	Gayla Y. Paschall
Arnold D. Froese	Gayla Scott Perkins
Stella D. Garcia-Lopez	Dave L. Provorse
Raymond J. Green	Kimberly D. Rogers
Brenda A. Hannon	William S. Rogers
Richard D. Harland	Karen L. Roper
Richard J. Harris	Lauren Scharff
Christian L. Hart	Kraig Schell
Linda S. Hynan	Ronald D. Taylor
Karen A. Jackson	Nathan L. Williams
Edward P. Kardas	Tracy E. Zinn
William E. Kelly	

Hotel Information

The Sheraton Gunter Hotel San Antonio is a historic property located in the heart of Downtown San Antonio just a block and a half from the Riverwalk. The Gunter Hotel was built in 1909 and was host to the first Southwestern Psychological Association meeting in held 1954.

SWPA contractually obligates itself with the convention hotel to occupy a minimum number of room nights and in return we receive use of the meeting rooms for no charge. Thus, it is very important that you lodge in the Sheraton Gunter and indicate your affiliation with SWPA when making reservations. The four ways to make reservations with the Gunter are 1) complete the form inserted with the program and mail it to the Gunter, 2) complete the form inserted with the program and fax it to the Gunter at to (210) 227-3299, 3) download the form electronically from the SWPA web page at www.swpsych.org and email it to reservations@gunterhotel.com, or 4) phone in your reservations at (210) 227-3241. Reservations obtained by other methods will not assist SWPA in meeting its obligation to the hotel. Thank you for your support.

The SWPA Convention room rate is \$129 for a standard room with up to four people. Hotel suites are available at an additional charge.

The Sheraton Gunter Hotel San Antonio, TX
205 East Houston Street
San Antonio, Texas 78205
Phone (210) 227-3241
Fax (210) 227-3299

Parking

Valet parking is available for a cost of \$14.00 per day. Guests who choose to use this service are granted unlimited entry/exit to the parking facilities.

Unsecured self parking is available across the street from the Sheraton Gunter.

Local Transportation

Transportation to the hotel may be obtained by shuttle, taxi, or rental car.

Shuttle: The San Antonio Airport Shuttle (SATRANS) offers service to the Sheraton Gunter and various other hotels from the airport. Round-trip fare is approximately \$16.00.

Taxi: A listing of taxi services and their numbers can be found at <http://www.thecityofsanantonio.com/taxi/>

Rental Car: Alamo 1-800-327-9633; AVIS 1-800-331-1212; Hertz 1-800-654-3131; National 1-800-227-7368; Enterprise 1-800-rent-a-car

Driving Directions To The Sheraton Gunter Hotel

From the North

Travel on Interstate 10 West until you come to Interstate 37 North. Proceed on Interstate 37 North and exit at Commerce Street. Turn left on Commerce Street and travel until you come to Navarro Street. Turn right on Navarro Street and continue to Travis Street. Turn left on Travis Street and continue to St. Mary's Street. The hotel drive is on the left.

From the South

Take Interstate 37 North and exit at Commerce Street. Turn left on Commerce Street and continue to Navarro Street. Turn right on Navarro Street. Stay on Navarro Street until you come to Travis Street. Turn left on Travis Street and proceed to St. Mary's Street. Turn left on St. Mary's and the hotel drive is on the left.

From the East

Proceed on Interstate 37 /state Highway 281 South into downtown. Take the Commerce Street exit and turn right onto Commerce Street. Make a left onto Alamo Plaza and continue until you come to Travis Street. Turn left onto Travis Street and continue to St. Mary's Street where you will turn left. The entrance to the hotel will be on the left.

From the West

Take Interstate 35 North to Interstate 37 South and exit at Commerce Street. Turn right on Commerce Street and continue to Navarro Street. Turn right on Navarro Street and travel until you come to Travis Street. Turn left on Travis Street and follow this to St. Mary's Street. Turn left on St. Mary's Street and the hotel drive is on the left.

Registering for the 2004 50th Anniversary Southwestern Psychological Association Convention

Instructions to Register for the Convention

On-site registration fees are \$35.00 for students; \$45.00 for Associate members; \$60.00 for SWPA members and non-members.

For the Southwestern Psychological Association, the convention registration fee is the same as the annual membership dues. So when a Full Member pays the \$50, an Associate Member pays \$35, and a Student Member pays the \$25 to join SWPA, they are also paying for their convention registration. Thus, register for the SWPA convention means joining SWPA and here are the few easy steps to join.

1. Go to our webpage at www.swpsych.org and from the menu on the left side of the page, click on the link titled "Joining SWPA" which appears under the Membership heading.
2. Follow the instructions on each screen, completing all of the requested information, especially the information about your mailing address. Should you have any questions, please contact Ed Kardas at epkardas@saumag.edu or 870-235-4231.
3. Send your membership dues as a check or money order payable to the Southwestern Psychological Association to Ray Russin, SWPA Secretary/Treasurer, 2354 River Trail Rd., Salina, KS 67401-8943

Please join before March 1, 2004 for two reasons. First, joining after March 1 means paying an additional \$10 last charge so that becoming a Full Member is \$60, becoming an Associate Member is \$45, and becoming a Student Member is \$35. Second, joining after March 1 means that you not receive your badge and program in the mail before the convention. Instead, you will pick up your badge and program at the Registration Desk in San Antonio.

We, the officers of the Southwestern Psychological Association, work arduously each year to ensure an outstanding yet affordable convention. 2004 will be an especially memorable convention as we celebrate 50 years of psychology in the southwest. Please come and help us celebrate the best of psychology.

Registration will take place in the Pre-Function area (see map on page 13) located on the third floor of the Sheraton Gunter. Registration hours are Wednesday, April 7, 5:00 p.m.-9:00 p.m.; Thursday, April 8, 8:00 a.m.-5:00 p.m.; Friday, April 9, 8:00 a. m.-5:00 p. m.; and Saturday, April 10, 8:00 a.m.-10:00 a.m.

Continuing Education Workshop Information

Several Continuing Workshops are scheduled for this year's meeting. These workshops offer up-to-date training for psychologist in various areas. Workshop fees may be paid during the SWPA conference. Workshop registration will take place in the Pre-Function area (see map on page 13) located on the third floor of the Sheraton Gunter.

Audio-Visual Policy

SWPA provides a screen and overhead projector in all meeting rooms where members present papers, workshops, or symposia. If members need any other audio-visual equipment, they are responsible for making their own arrangements and payment. The security and storage of any equipment brought to the meeting site are the sole responsibility of the individual bringing or renting the equipment for the meeting. SWPA is not responsible for the security and storage of equipment brought to the meeting site by private arrangement.

If you have any questions regarding this policy or need assistance procuring equipment, please contact SWPA Convention Manager Bob Newby (newby@tarleton.edu).

The Sheraton Gunter Hotel Meeting Facilities

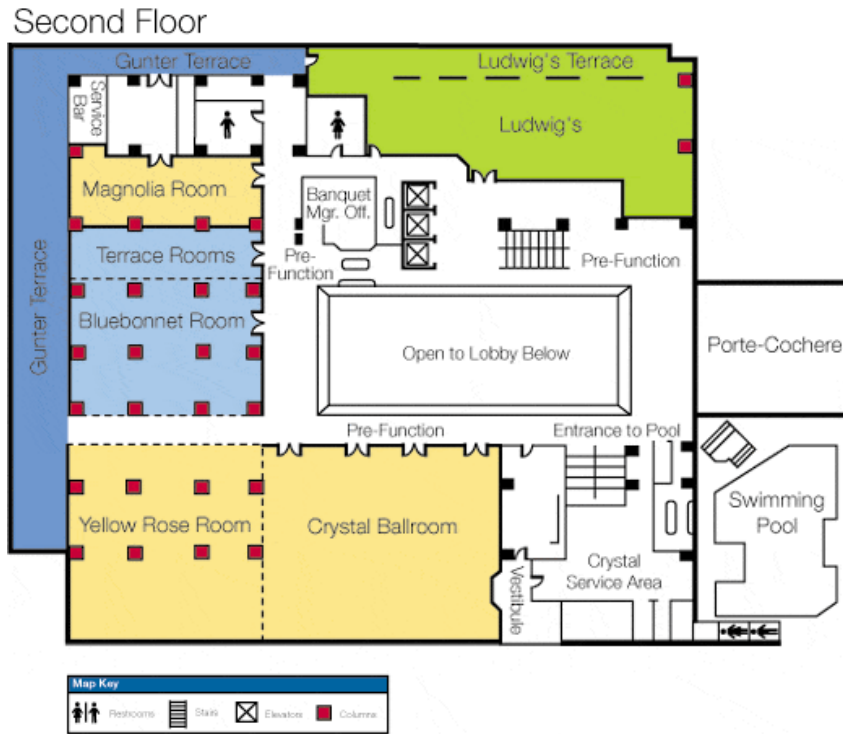

All Poster Sessions are held in the Robert Johnson Room
located on the **First Floor**.

The Sheraton Gunter Hotel Meeting Facilities

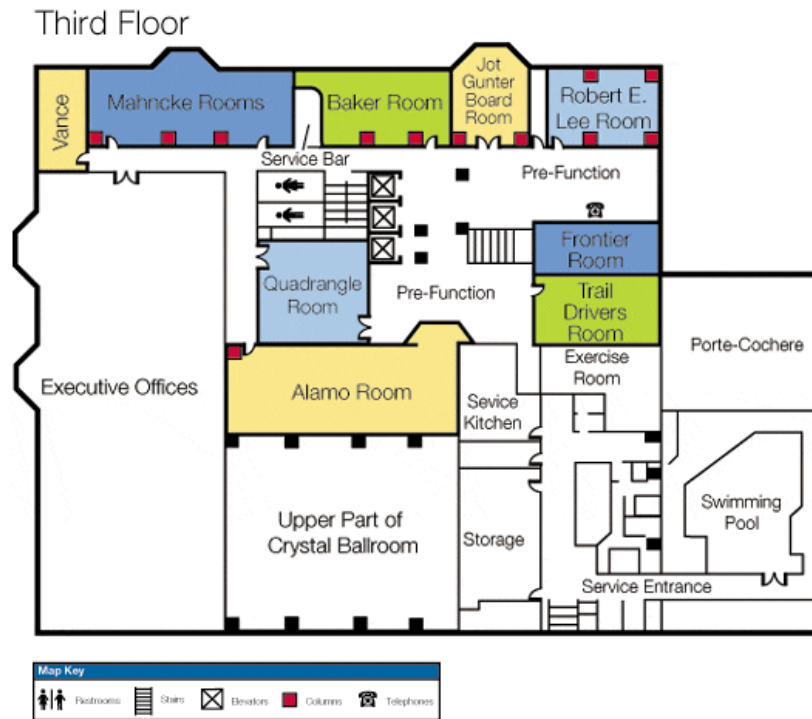

All Poster Sessions are held in the Robert Johnson Room
located on the **First Floor**.

Wednesday, April 7, 2004

SWPA Executive Council Meeting

Wednesday 6:00 p.m.- 8:00 p.m. Baker Room

Thursday, April 8, 2004

SWPA Symposium: Religion-Mental Health

Thursday 8:00 a.m.- 10:00 a.m. Magnolia Room

Chaired by Scott Perkins

**The Religion-Mental Health Relationship Reexamined:
Controversy, Complement, or Coexistence?**

Scott Perkins	<i>Abilene Christian University</i>
Carrie Hale	<i>Abilene Christian University</i>
Trey Laminack	<i>Abilene Christian University</i>
Richard A. Beck	<i>Abilene Christian University</i>
Billy Joe Riggs	<i>Abilene Christian University</i>
Boone Martin	<i>Abilene Christian University</i>
Danelle Leverett	<i>Abilene Christian University</i>
Rachel Bowden	<i>Abilene Christian University</i>

Psi Chi Poster Session

Thursday 8:00 a.m.- 9:15 a.m. Robert Johnson Room

**Board 1: A Meta-Analysis of the Impact of Divorce on
Children's Self-Concept**

Jacqueline S. Aguirre	<i>Our Lady of the Lake University</i>
Alejandra Mata	<i>Our Lady of the Lake University</i>
Deborah Matusko	<i>Our Lady of the Lake University</i>
Amanda Meador	<i>Our Lady of the Lake University</i>
Angela Pena	<i>Our Lady of the Lake University</i>

Board 2: Re-Meta-Analysis of Media Violence and Aggressive Behavior

Helen Hoang	<i>University of St. Thomas, Houston</i>
April L. Delmar	<i>University of St. Thomas, Houston</i>
Freddy Viafara	<i>University of St. Thomas, Houston</i>

Board 3: Meta-Analysis of the Deterrence Effect of the Death Penalty

Deanna Alcalá	<i>University of St. Thomas, Houston</i>
Angelica Coronado	<i>University of St. Thomas, Houston</i>
Lynette Fontenot	<i>University of St. Thomas, Houston</i>
Amanda Guterrez	<i>University of St. Thomas, Houston</i>
Heather Pikett	<i>University of St. Thomas, Houston</i>
Karla Solis	<i>University of St. Thomas, Houston</i>
Amber Vaughn-Garcia	<i>University of St. Thomas, Houston</i>

Board 4: Life After College?: Factors Influencing Seniors' Post-Graduation Plans

Nicole Blanchett	<i>Southwestern University</i>
Erin Puckett	<i>Southwestern University</i>
Sarah Barnett	<i>Southwestern University</i>
Jacqueline Muir-Broadus	<i>Southwestern University</i>

Board 5: Mr. and Mrs. Know-It-All: Perceptions of Individuals Demonstrating Male Answer Syndrome

Aubrey D. Buckert	<i>Southwestern University</i>
Genevieve M. Pruneau	<i>Southwestern University</i>
Traci A. Giuliano	<i>Southwestern University</i>

Board 6: The Importance of Penis Size and Breast Size to Male and Female College Students

Meagen M. Carswell	<i>Stephen F. Austin State University</i>
Katrina M. Killgore	<i>Stephen F. Austin State University</i>
Robert Bogdan	<i>Stephen F. Austin State University</i>
Dianna C. Jackson	<i>Stephen F. Austin State University</i>

Board 7: Age and Gender Effects on Jury Decision Making

Travis Langley	<i>Henderson State University</i>
Tina Cates	<i>Henderson State University</i>

Board 8: Assessing Men's Fitness' Fattest City Rankings

Brittany Clark

*University of St. Thomas, Houston***Board 9: Interparental Conflict Associated With Parent-Young Adult Child Attachment Security**

Tara L. Cummings

Southwestern University

Bryan D. Neighbors

Southwestern University

Ellen Gass

Southwestern University

Amy Casbeer

*Southwestern University***Board 10: A Meta-Analysis of Adolescent Drug and Alcohol Treatment Programs**

Laura Dipette

University of St. Thomas, Houston

Al Karash

*University of St. Thomas, Houston***Board 11: Dimensions of Romantic Attachment and Symptoms of Psychopathology**

Mary A. Erwin

Southwestern University

Bryan D. Neighbors

Southwestern University

Elizabeth Vera

St. Mary's University

Heidi Tesch

*Southwestern University***Board 12: Influence of Text Difficulty and Instructions on Reading Comprehension of consent Forms**

Alicia Hardy

Stephen F. Austin State University

Laura Olson

Stephen F. Austin State University

Shamekia Hopson

Stephen F. Austin State University

Leslie White

Stephen F. Austin State University

Amber Pierce

*Stephen F. Austin State University***Board 13: The Effects of CRT and LCD Displays on Acuity Tasks**

Ann-Jinette Hess

*University of Texas at San Antonio***Board 14: Professor "Religion" and Student Perceptions: A Replication and Extension**

Todd Howle

Stephen F. Austin State University

Board 15: Drug Use Among College Students by the Mexico Border

Angelica M. Huerta	<i>The University of Texas-Pan American</i>
Sandra A. Salazar	<i>The University of Texas-Pan American</i>
Stina S. Garibay	<i>The University of Texas-Pan American</i>

Board 16: Beliefs About What Causes Social Success: Changes During Early Adolescence

Rochelle James	<i>Loyola University-New Orleans</i>
----------------	--------------------------------------

Board 17: The Relationship Between Class Attendance and Personally Paying for College

Amber R. Koblitz	<i>Baker University</i>
------------------	-------------------------

Board 18: Eating Disorder Traits and Romantic Attachment

Brandy N. Ledbetter	<i>Southwestern University</i>
Bryan D. Neighbors	<i>Southwestern University</i>

Board 19: Relationship Satisfaction of Maximizers and Satisficers

Kristal Parrish	<i>Stephen F. Austin State University</i>
Michelle Lebeck	<i>Stephen F. Austin State University</i>
Crystal Little	<i>Stephen F. Austin State University</i>
Cherie Rosenboom	<i>Stephen F. Austin State University</i>

Board 20: Pink Slips and Black Cats: The Relationship Between Stress and Superstition

Abigail L. Riggs	<i>Southwestern University</i>
Erin E. Crockett	<i>Southwestern University</i>
Traci A. Giuliano	<i>Southwestern University</i>

Board 21: The Effects of Instruction and Noise on Test Performance

Taylor Sloan	<i>Stephen F. Austin State University</i>
Clark Haynes	<i>Stephen F. Austin State University</i>
Missy Jensen	<i>Stephen F. Austin State University</i>
Thomas Masterson	<i>Stephen F. Austin State University</i>
Hazel Arguello	<i>Stephen F. Austin State University</i>

Board 22: Sexist Language in Contemporary Magazines

Andrea L. von Briesen	<i>St. Edward's University</i>
-----------------------	--------------------------------

Board 23: Age Changes in Fat Intake and Effects Upon Memory Performance

Sheila Hixson

McNeese State University

Brandy Moniham

McNeese State University

Carl Bartling

McNeese State University

Board 24: Type of Goal-Setting, “Task Difficulty”, and Self-Esteem: Is There an Interaction?

Ugochi Onyejiaka

Stephen F. Austin State University

Board 25: Effects of Treatment Scenario on Participants’ Evaluation of Depression

Laura Olson

Stephen F. Austin State University

Board 26: Who Dunit? Attractiveness Stereotypes and Children's Responses to Leading Questions

Rebecca Stelter

Southwestern University

Ashley Still

Southwestern University

Kamini Verma

Southwestern University

Jacqueline Muir-Broadus

Southwestern University

SWPA Address: About Saul Sells

Thursday 8:30 a.m.- 8:55 a.m.

Crystal Ballroom

Chaired by Ludy T. Benjamin, Jr.

Saul B. Sells Lecture-*Chaired by Kenneth A. Weaver***Norman Anderson***American Psychological Association***Psychology as a Health Profession:
Challenges and Opportunities**Thursday 9:00 a.m.- 9:50 a.m.
Crystal Ballroom

This presentation will trace the recent history of the movement for psychology to play a larger role in health care and health science. It will provide a 25-year retrospective of the movement, and describe what needs to happen next for psychology to be fully recognized as an equal partner in the health care arena.

SAMR Workshop**Bruce Thompson***Texas A&M University and Baylor College of Medicine***Interpreting Weights Versus Structure Coefficients in
Regression, Factor Analysis, and All Parametric Methods**Thursday 9:00 a.m.- 12:00 p.m.
Mahncke Room

In all parametric methods, weights are applied to variables as part of computing effect sizes. Also important are the correlations of the variables with the effect-size related variables created in each analysis; these are called structure coefficients. Using examples from his new 2004 book published by APA, Professor Thompson will present a user-friendly introduction to recommended strategies for interpreting all parametric statistical results.

Fee: \$15

SCPA Paper Session I

Thursday 9:00 a.m.- 11:00 a.m.

Quadrangle Room

Chaired by W. Robert Batsell, Jr.

Within-Compound Associations are not Sufficient to Produce Taste-Mediated Odor Potentiation

W. Robert Batsell, Jr.

Kalamazoo College

Joanna Schnelker

Kalamazoo College

John Sharpe

Kalamazoo College

John D. Batson

*Furman University***The Role of Head Direction Cells in Spatial Navigation**

Russell J. Frohardt

*University***The Effect of Differential Outcomes for Feeder Position as Compared to Reinforcer Quality on Acquisition of a Discrimination Task in Rats**

Karen L. Roper

*Wake Forest University***Intraspecific Variation of Anti-Predator Responses in Garter Snakes (*Thamnophis Sirtalis*)**

Mark A. Krause

*University of Portland***New Procedure for Assessing Foraging Strategies in Fish**

Elizabeth Cheaney

Southwestern University

Jesse E. Purdy

*Southwestern University***Tick Tock an Interval Clock: Timing in *Betta Splendens***

Lauren Squyres Duffy

Texas Christian University

Donna Campbell

Texas Christian University

Jennifer Higa

*Texas Christian University***SWPA Social and Personality Poster Session I**

Thursday 9:30 a.m.- 10:45 a.m.

Robert Johnson Room

Board 1: College Alcohol Use: The Influence of Social and Personality Factors

Marilyn D. Van Leeuwen

William Woods University

Christy L. McPherson

William Woods University

Board 2: Selective Prevention of Eating Disorders in Sorority Members

Lisa Smith	<i>Trinity University</i>
Carolyn B. Becker	<i>Trinity University</i>
Allison C. Jessee	<i>Trinity University</i>
Anna C. Ciao	<i>Trinity University</i>
Laura J. Hemberger	<i>Trinity University</i>
Jennifer L. Bell	<i>Trinity University</i>

Board 3: Response Latency and Faking: Do Exaggerators Really Take Longer?

George Dudley	<i>Behavioral Sciences Research Press</i>
Ira Bernstein	<i>University of Texas at Arlington</i>

Board 4: Locus of Control, Self-Esteem, Gender and Freshman College Adjustment

Martha L. Spriggs	<i>University of Mary Hardin-Baylor</i>
Rebecca A. Kasner	<i>University of Mary Hardin-Baylor</i>
Tonya R. Hammer	<i>University of Mary Hardin-Baylor</i>

Board 5: Forgiveness and Sexual Abuse

Rachel L. Allen	<i>Williams Baptist College</i>
-----------------	---------------------------------

Board 6: Threat Levels in Facial Configurations Representing Threat, Seduction, or Romantic Attraction

Joe McGahan	<i>University of Louisiana-Monroe</i>
Adam T. Blancher	<i>University of Louisiana-Monroe</i>
Jason L. Burnett	<i>University of Louisiana-Monroe</i>
J. David Williamson	<i>University of Louisiana-Monroe</i>

Board 7: Happiness in People, Places, Things, and Activity

Don R. Lucas	<i>Alamo Community College, San Antonio</i>
Carla Kaylor	<i>Alamo Community College, San Antonio</i>
Ignacio R. Magaloni	<i>Alamo Community College, San Antonio</i>

Board 8: Attachment and PTSD Related Cognitions: Cognitive Vulnerabilities to Psychopathology

Lisa Elwood	<i>University of Arkansas at Fayetteville</i>
Nathan L. Williams	<i>University of Arkansas at Fayetteville</i>
Anne M. Fisher	<i>University of Arkansas at Fayetteville</i>

Board 9: Myers-Briggs and SDS Patterns in Psychology Majors: Do They Fit the Expected Profile?

Karen A. Jackson

*Texas Women's University***Board 10: Communicator Image and Myers-Briggs Type Indicator (MBTI) Extraversion-Introversion**

Donald A. Loffredo

*University of Houston-Victoria***Board 11: Credit Card Debt and Student Personal Responsibility**

Sangeeta Singg

Angelo State University

Keith Hoelscher

Angelo State University

Allison Perez

*Angelo State University***Board 12: Relations Between Personality Traits on Relationship Satisfaction**

Diana L. Sanchez

*St. Mary's University***Board 13: Narcissism and Patterns of Romantic Attraction: Self-Enhancement and Accommodation**

Jamie Wilson

Lamar University

Joanne S. Lindoerfer

*Lamar University***Board 14: Relations Between Gender, Personality, Family Relationships, and Substance Dependence**

Sandra Rodriguez

*St. Mary's University***Board 15: Individual Differences in the Written Expression of Emotion**

Leslie J. Rogers

*University of Texas at San Antonio***Board 16: Validation Studies Examining Personality and College Student Success**

James H. Martin

University of Missouri-Rolla

Robert L. Montgomery

University of Missouri-Rolla

Dee H. Montgomery

University of Missouri-Rolla

Board 17: Relationship of Coping Methods on Anxiety, Depression, and Academic Performance

Janice C. Marceaux	<i>McNeese State University</i>
Brooke D. Mayeaux	<i>McNeese State University</i>
Sarah J. Miller	<i>McNeese State University</i>
Carl Bartling	<i>McNeese State University</i>

Board 18: The Relationship Between Emotional Intelligence and Trait Anxiety

Tommie Hughes	<i>Texas A&M-Texarkana</i>
---------------	--------------------------------

Board 19: Body Image and Personality: Is There a Trait that Links the Two?

Jennifer L. Gibson	<i>Tarleton State University</i>
--------------------	----------------------------------

Board 20: Self- and Observer-Ratings of Personality in Adolescent Conduct Disorder

Lauren M. Kirshbaum	<i>University of Texas at Houston</i>
---------------------	---------------------------------------

Board 21: Comparing Personality Characteristics of Adolescents With and Without Conduct Disorder

David Trotter	<i>University of Texas at Houston</i>
---------------	---------------------------------------

Board 22: Attachment and Psychopathology: Attachment Security, Axis I Symptoms, and Gender

Genevieve M. C. Pruneau	<i>Southwestern University</i>
Bryan Neighbors	<i>Southwestern University</i>
Elizabeth Vera	<i>Southwestern University</i>

Board 23: Birth Order and Career Exploration Among Graduate Education Majors

Catherine H. Price	<i>University of Louisiana-Monroe</i>
Jean M. Low	<i>University of Louisiana-Monroe</i>
William G. McCown	<i>University of Louisiana-Monroe</i>

Board 24: Assumptions about Human Nature and the Big Five Personality Factors

Paula J. Womack	<i>Texas Tech University</i>
Darcy A. Reich	<i>Texas Tech University</i>

Board 25: Personality Predictors of Product Preference

Mark Hartlaub

Texas A&M-Corpus Christi

Jacqueline P. DiFiore

Texas A&M-Corpus Christi

Jennifer L. Barnum

*Texas A&M-Corpus Christi***Board 26: Personality Contributions to Belief in Paranormal Phenomena**

Cara L. Smith

Regent University

Judith Lynn Johnson

*Regent University***Board 27: Personality as a Predictor of College Student Success**

Robert L. Montgomery

University of Missouri-Rolla

James H. Martin

University of Missouri-Rolla

Dee H. Montgomery

*University of Missouri-Rolla***Board 28: The Looming Maladaptive Style: A Cognitive Diathesis to Anxiety**

Mica A. Lunt

*University of Arkansas at Fayetteville***SWPA Invited Address**-Chaired by *Kenneth A. Weaver***Rolando Diaz-Loving***Universidad Nacional Autonoma de Mexico**(National Autonomous University of Mexico)***Research on the Dark and Kind Sides of Mexican Couples**

Thursday 10:00 a.m.-10:50 a.m.

Crystal Ballroom

Research on a bio-psycho-socio-cultural model of couple interactions will be presented and its effects on conflict, emotional reactions of anger, depression, anxiety and hope, support and violence, mental health, psychosomatic reactions and marital satisfaction.

SWPA Symposium: Partner Abuse

Thursday 10:00 a.m.- 12:00 a.m. Bluebonnet Room

Chaired by Saori Rivera

An Integrated Group Treatment Approach for Male Partner Abusers

Saori Rivera	<i>Texas A&M-College Station</i>
Ashley D. Barnes	<i>Texas A&M-College Station</i>
Marie B. Lamothe-Francois	<i>Texas A&M-College Station</i>
Joshua P. Bias	<i>Texas A&M-College Station</i>
David Lawson	<i>Texas A&M-College Station</i>

SWPA Symposium: Gender and Academe

Thursday 10:00 a.m.- 12:00 a.m. Yellow Rose Room

Chaired by Mary Ellen McNaughton-Cassill

Faculty Perceptions Regarding Gender and Academic Roles

Mary Ellen McNaughton-Cassill	<i>University of Texas at San Antonio</i>
Jo A. Meier	<i>University of Houston-Clear Lake</i>
Jill Walters	<i>Hardin-Simmons University</i>
Heidi E. Ziemer	<i>Rice University</i>
Molly E. Lynch	<i>Northern Virginia Community College</i>
Sue W. Lucas	<i>Hardin-Simmons University</i>
Nathan L. Williams	<i>University of Arkansas at Fayetteville</i>

SWPA Undergraduate Research Competition

Thursday 10:00 a.m.-12:00 a.m. Baker

Chaired by Edward P. Kardas

Do Fashion Magazines and Mirrors Affect Undergraduate Women's Self-Perceptions?

Melissa M. Crane	<i>Emporia State University</i>
Nicholas A. Baumgartner	<i>Emporia State University</i>
Cathy A. Grover, <i>Sponsor</i>	<i>Emporia State University</i>

Recognition and Perception of Whole-Tone, Natural Minor, Harmonic Minor, and Melodic Minor Scales

Robin E. White	<i>Texas Lutheran University</i>
Lawrence B. Lewis, <i>Sponsor</i>	<i>Texas Lutheran University</i>

Cross-Cultural Creativity of Japanese and American Students

Amelia L. Nelson *University of Central Oklahoma*
Kathleen M. Donovan, *Sponsor* *University of Central Oklahoma*

Cognitive Styles as Predictors of Smoking Temptation Among Females

Jeannine P. Tamez *Our Lady of the Lake University*
Loranel M. Graham, *Sponsor*, *Our Lady of the Lake University*

The Effect of Stimulus Type and Emotion Suppression on Memory and Mood

Lauren H. Schwartz *University of Central Oklahoma*
Kathleen M. Donovan, *Sponsor* *University of Central Oklahoma*

A Test of Dovidio and Gaertner's (1998) Integrated Model of Racism

Anna L. Barnes *Southwestern Oklahoma State University*
Courtney L. Phillips *Southwestern Oklahoma State University*
Paul R. Nail, *Sponsor* *Southwestern Oklahoma State University*

Gender Differences in Route Learning: Role of Orientation and Landmarks

Angel M. Martinez *Lamar University*
Edythe E. Kirk, *Sponsor* *Lamar University*

Presence of Music in One's Studying Environment and Reading Comprehension

Emily A. Farris *Midwestern State University*
Jacqueline L. Cuevas, *Sponsor* *Midwestern State University*

The Effect of Servers' Personalization and Reciprocity on Restaurant Tipping

Rachel M. Harke *Baker University*
Rand Ziegler, *Sponsor* *Baker University*

SWPA Symposium-Research and Practice

Thursday, 10:00 a.m.- 11:30 a.m. Magnolia Room

Chaired by George B. Yancey

The Gap Between Research Recommendations and Practice

George B. Yancey

Emporia State University

Dena Matzenbacher Smith

McNeese State University

Lawrence S. Dilks

McNeese State University

Chrisanne Christensen

*Southern Arkansas University***SWPA Symposium- Social Psychology**

Thursday 10:00 a.m.-12:00 p.m. Ludwig's Room

Chaired by Richard Beck

Back to the Future: Replication and Reappraisal of Five Classic Social Psychological Experiments

Richard A. Beck

Abilene Christian University

Conrad Hester

Abilene Christian University

Danel Leverett

Abilene Christian University

Adam Looney

Abilene Christian University

Shanna Tooley

Abilene Christian University

Rebekah Duke

Abilene Christian University

Brittany Haws

Abilene Christian University

Brandi Patton

Abilene Christian University

David Riggs

Abilene Christian University

Elizabeth Sibrian

Abilene Christian University

Jenna Trapasso

Abilene Christian University

Kristi Lippert

Abilene Christian University

Kristen Parker

Abilene Christian University

Jill Rowland

Abilene Christian University

Jennifer Voiles

Abilene Christian University

Therez Ephraim

Abilene Christian University

Trishawna Gailes

Abilene Christian University

Shirley Glaze

Abilene Christian University

Nichelle Wall

Abilene Christian University

SCPA Invited Address-Chaired by *Charles W. Hennig***Daniel D. Moriarty***University of San Diego and California Wolf Center***Mexican Wolf Species Survival Program: Behavioral Issues**

Thursday 11:00 a.m.-11:50 a.m.

Alamo Room

SWPA Paper Session-Human Factors and Industrial/Organizational

Thursday 11:00 a.m.- 12:15 p.m. Trail Driver Room

Chaired by Kraig Schell

The Effects of Moral Credentialing in Organizational Settings on Perceptions of Discrimination.Alexis N. Smith *Rice University*Michelle Hebl *Rice University***The University as a Workplace: Motivators and Satisfaction**Jason H. Hill *Texas A&M-Commerce***Networking, Duration of Unemployment and the Job Seeking Index**Shannon L. Goodson *Behavioral Sciences Research Press*Trelitha R. Bryant *Behavioral Sciences Research Press*George Dudley *Behavioral Sciences Research Press***Predicting Performance in Air-Traffic Control**Aaron M. Perez *Texas Tech University*Francis T. Durso *University of Oklahoma at Norman***Control Beliefs and Workload Shifts in Quality Control Performance**Kraig Schell *Angelo State University*Stephany M. Havens *Angelo State University*Kurtis R. Neal *Angelo State University*

CTUP/CUPP Teaching and Department Activities Poster Session

Thursday 11:00 a.m.-12:15 p.m. Robert Johnson Room

Board 1: Teaching Psychology Using Technology: Student Performance, Attendance, and Satisfaction

Scott A. Hutchens *Delta State University*

Board 2: Undergraduate Research Database: Original Ideas for Projects in Social Psychology

Ralph J. McKenna *Hendrix College*

Board 3: Education in Abnormal Psychology and Perceptions of Mental Illness

Laura M. Olson *Stephen F. Austin State University*

Tracy E. Zinn *Stephen F. Austin State University*

Board 4: General Psychology Textbooks II: The Gustatory Sense

Richard D. Harland *West Texas A&M University*

Abby Watkins *West Texas A&M University*

Board 5: Internationalizing the Psychology Curriculum: Resources for Teachers

John M. Davis *Texas State University*

Catherine A. Bower *Texas State University*

Richard Brian Cano *Texas State University*

Krystle Frahm *Texas State University*

Russell P. Corrigan *Texas State University*

Board 6: Reflections About “Superstar” Graduate Students Revisited

Michael J.T. Leftwich *Emporia State University*

Autumn L. Backhaus *Emporia State University*

Jennifer Fairchild *Emporia State University*

Kenneth A. Weaver *Emporia State University*

Cathy A. Grover *Emporia State University*

Board 7: Student Incivility: Students Annoying Others in the Classroom

Molly E. Lynch *Northern Virginia Community College*
 Mary E. McNaughton-Cassill *University of Texas at San Antonio*

Board 8: Encouraging Academic Careers in Undergraduate Psychology Students

Melinda Burgess *Southwestern Oklahoma State University*

Board 9: The Effects of Diversity Information on Student Perceptions of Education

Elizabeth A. Hemenway *Stephen F. Austin State University*
 Lesley P. Snow *Stephen F. Austin State University*
 Patricia Foster *University of Houston-Downtown*
 Tracy E. Zinn *Stephen F. Austin State University*

Board 10: Social Support and College Satisfaction Among Traditional and Nontraditional Students

Monica B. Pinalez *University of Texas-Pan American*
 Mirella Roman Martinez *University of Texas-Pan American*
 Jerry Gomez *University of Texas-Pan American*
 Iliana M. Perez *University of Texas-Pan American*
 Melanie A. Peralez *University of Texas-Pan American*
 Kristin L. Croyle *University of Texas-Pan American*

Board 11: The Relationship Among Procrastination, Anxiety, and College Students' Grades

Brooke D. Mayeaux *McNeese State University*
 Sarah J. Miller *McNeese State University*
 Janice C. Marceaux *McNeese State University*
 Carl Bartling *McNeese State University*

Board 12: Inter-teaching vs. "Traditional" Methods of Instruction: A Laboratory Analysis

Bryan K. Saville *Stephen F. Austin State University*
 Tracy E. Zinn *Stephen F. Austin State University*
 Marcus P. Elliott *Stephen F. Austin State University*

**Board 13: Evaluating Experimental Course Instruction:
An Instrument to Measure Student Perceptions**

Cayla R. Teal	<i>Baylor College of Medicine</i>
Victoria A. Mosack	<i>Wichita State University</i>
Charles A. Burdsal	<i>Wichita State University</i>

**Board 14: Including Ethics Training in an NSF Sponsored
Undergraduate Research Experience**

Shelia M. Kennison	<i>Oklahoma State University</i>
--------------------	----------------------------------

**Board 15: Desirable Teaching Qualities Transcend the Nature
of the Student, Again**

Robert Mowrer	<i>Angelo State University</i>
Melissa G. Gwathmey	<i>Angelo State University</i>

**Board 16: Organizing Chaos: An Analysis of Readability and
Thematic Trends**

Daniel S. Glaser	<i>Texas Lutheran University</i>
Carolyn S. Turner	<i>Texas Lutheran University</i>
Scott A. Bailey	<i>Texas Lutheran University</i>

**Board 17: Organizing Chaos: Visual Information in Caldecott
Medal Winning Books**

Scott A. Bailey	<i>Texas Lutheran University</i>
-----------------	----------------------------------

**Board 18: Profile of the Watson-Glaser Critical Thinking
Appraisal- Short Form**

Bernadette M. Gadzella	<i>Texas A&M-Commerce</i>
James R. Stacks	<i>Texas A&M-Commerce</i>
Rebecca Camp Stephens	<i>Texas A&M-College Station</i>
William G. Masten	<i>Texas A&M-Commerce</i>

**Board 19: Relationships Among Critical Thinking Scores,
Learning Styles, and Course Grades**

Bernadette M. Gadzella	<i>Texas A&M-Commerce</i>
James R. Stacks	<i>Texas A&M-Commerce</i>

**Board 20: The Success of Virtual Research (“E-based”) Teams
for Nontraditional Psychology Students**

William McCown	<i>University of Louisiana-Monroe</i>
----------------	---------------------------------------

Board 21: Sharing Laboratory Space Within the Department

Mary Brazier
Mukul Bhalla

Loyola University-New Orleans
Loyola University-New Orleans

Psi Chi Advisor Luncheon

Thursday 12:00 p.m.-1:30 p.m.
Chaired by John Davis

Ludwig's Room

SWPA Graduate Research Competition

Thursday 12:00 p.m.-1:50 p.m.
Chaired by Kenneth A. Weaver

Baker Room

Conduct Disorder Age of Onset and Reward-Directed Impulsivity

Dawn M. Marsh *University of Texas at Houston*
Donald M. Dougherty *University of Texas at Houston*
Charles W. Mathias *University of Texas at Houston*
Donald M. Dougherty, *Sponsor* *University of Texas at Houston*

The Stigma of Counseling: Perceived Competence of Those Receiving Counseling

Suzanne R. Heflin *University of Central Oklahoma*
Kathleen M. Donovan, *Sponsor* *University of Central Oklahoma*

An Investigation of the Relationship Between Biofeedback and Locus of Control

Maria Tortorice *University*
Helen D. Just, *Sponsor* *University*

Latino Family Acculturation, Conflicting Cultural Values, and Family Disruption

Rebecca L. Falkenberg *University of Texas at San Antonio*
Stella D. Garcia-Lopez, *Sponsor* *University of Texas at San Antonio*

Hand Washing Behavior of Women in Public Restrooms

Amanda M. Stinson *Loyola University-New Orleans*
Kim Ernst, *Sponsor* *Loyola University-New Orleans*

Nonlinear Assembly of Visual Features

Philip L. Armstrong *Texas A&M-Commerce*
 Raymond J. Green, *Sponsor* *Texas A&M-Commerce*

SWPA Symposium-Cognition and Emotion

Thursday 12:00 p.m.-2:00 p.m. Bluebonnet Room

Chaired by D. Theron Stimmel

Cognitive, Emotional, and Physiological Factors in the Perception of Pain

D. Theron Stimmel	<i>Southwest Texas State University</i>
Carol Crayton	<i>Southwest Texas State University</i>
Amanda C. Angst	<i>Southwest Texas State University</i>
James Frost	<i>Southwest Texas State University</i>
Lindsay Peques	<i>Southwest Texas State University</i>

SAMR/SWPA Invited Address-*Chaired by Linda Hynan***C. R. (Rick) Snyder**

University of Kansas

The Science of Hope

Thursday 1:00 p.m.-1:50 p.m.

Crystal Ballroom

Dr. Snyder will share his views about the viability of establishing a scientific model of hope and how he discovered the components of hopeful thinking as he operationalizes it. The speaker will review his research on how to raise hope in children and adults and will describe the findings on the question, "Is there ever such a thing as false hope?"

SWPA Paper Session-Culture, Ethnicity, and Gender Issues

Thursday 1:00 p.m.- 2:15 p.m.

Yellow Rose Room

Chaired by Laurence A. French

Post-NAFTA/9-11 Impact on Mexican Education in America

Laurence A. French

Prairie View A&M University

Exploring Ethnic Differences in Individualism, Collectivism, and Familism

Noelle M. Fritz

University of Texas at San Antonio

Ethnic Identity & Egalitarianism: Interaction Between Gender & Acculturation

Virginia V. Wood

University of Texas at Brownsville

Ethel K. Cantu

University of Texas at Brownsville

A Cross-Cultural Study of Body Image: A Comparison of American and Indian Samples

Mukul Bhalla

Loyola University New Orleans

Cultural Tension and Sense of Place: An Ethnographic Case Study

Reyda L. Taylor

Ouachita Baptist University

Randall D. Wight

Ouachita Baptist University

SCPA Paper Session II

Thursday 1:00-2:00 p.m.

Quadrangle Room

Chaired by Brian Cusato

Can Pavlovian Conditioning Overcome the Negative Effects of Stress? Fertility Effects in Female Japanese Quail (*Coturnix Japonica*)

Leah Davis

Sweet Briar College

Brian Cusato

Sweet Briar College

Contextual Conditioning of Fertility in Male and Female Japanese Quail (*Coturnix Japonica*)

Kelly Gibbons

Sweet Briar College

Mindy Wolfrom

Sweet Briar College

Brian Cusato

Sweet Briar College

Microsatellite Markers Increase Reliability in Paternity Testing of Japanese Quail

R. Nicolle Matthews	<i>University of Texas at Austin</i>
Mary Ramsey	<i>University of Texas at Austin</i>
Michael Domjan	<i>University of Texas at Austin</i>
David Crews	<i>University of Texas at Austin</i>

SWPA Symposium-Behavioral Measures of Impulsivity

Thursday 1:00 p.m.-2:30 p.m. Magnolia Room

Chaired by Donald Dougherty

Behavioral Measures of Impulsivity Among At-Risk Samples

Donald M. Dougherty	<i>University of Texas at Houston</i>
Dawn M. Marsh	<i>University of Texas at Houston</i>
Charles W. Mathias	<i>University of Texas at Houston</i>

SWPA Developmental Poster Session

Thursday 1:30 p.m.- 2:45 p.m. Robert Johnson Room

Board 1: Schizophrenia in Adolescence

Tomme R. Actkinson	<i>University of Mary Hardin-Baylor</i>
--------------------	---

Board 2: Parent Relationships as a Framework for Future Relationships

Vanessa Avina	<i>St Mary's University</i>
---------------	-----------------------------

Board 3: Social Skills Impairments and Attention-Deficit/Hyperactivity Disorder

Tammy D. Barry	<i>Texas A&M-College Station</i>
Beth H. Garland	<i>Texas A&M-College Station</i>
Elizabeth S. Wiley	<i>Texas A&M-College Station</i>

Board 4: Psychological Advice on Parenting: 1925-1935

Sophia Tani	<i>Texas A&M-College Station</i>
Krystle Murillo	<i>Texas A&M-College Station</i>

Board 5: Importance of Parenting Efficacy and Satisfaction on Aggression/Conduct Problems

Beth H. Garland	<i>Texas A&M-College Station</i>
Tammy D. Barry	<i>Texas A&M-College Station</i>

**Board 6: National Anti-Drug Media Campaign Television Ads
Evaluation: Methodologies and Outcomes**

Harvey J. Ginsburg	<i>Texas State University</i>
Maria Czyzewska	<i>Southwest Texas State University</i>
Nicole Corich	<i>Texas State University</i>
Mary F. Miller	<i>Texas State University</i>
Jennifer Fenter	<i>Texas State University</i>

**Board 7: Are Parental Attachment Security and Adult Romantic
Attachment Styles Related?**

Ashley E. Hadsell	<i>Southwestern University</i>
Bryan Neighbors	<i>Southwestern University</i>
Erin L. Leverenz	<i>Texas A&M-College Station</i>

**Board 8: Internships: A Vehicle for Facilitating the
Development of Values in College Students**

Helen D. Just	<i>St. Edward's University</i>
Candice Wade	<i>St. Edward's University</i>
Alexia Rose Apollo	<i>St. Edward's University</i>
Jeannette E. Dianovich	<i>St. Edward's University</i>
Catherine B. Lacy	<i>St. Edward's University</i>

**Board 9: Predicting Freshman Adjustment: The Role of
Attachment to and Communication With Parents**

Helen D. Just	<i>St. Edward's University</i>
Sarah E. Henseler	<i>St. Edward's University</i>
Jeannette E. Dianovich	<i>St. Edward's University</i>
Candice Wade	<i>St. Edward's University</i>
Alexia Rose Apollo	<i>St. Edward's University</i>
Catherine B. Lacy	<i>St. Edward's University</i>

**Board 10: The Relationship Between the Detection of Mental
Retardation and Age**

Matt V. Sutton	<i>Williams Baptist College</i>
Charlotte A. Featherston	<i>Williams Baptist College</i>

Board 11: Age Differences in Sensitivity to Relationship Violence

Shana J. Sutcliffe

University of Houston-Clear Lake

Jo A. Meier

University of Houston-Clear Lake

Dipali Venkataraman

University of Houston-Clear Lake

SWPA Invited Address

Innovative Practices in Teaching Introductory Psychology: Animations and Quizzes

Gordon K. Hodge

University of New Mexico

Thursday 2:00 p.m.-2:50 p.m.

Crystal Ballroom

SCPA Invited Address-*Chaired by Jesse E. Purdy*

Patrick W. Moore

Space and Naval Warfare Systems Center in San Diego

Sensory Foundations of Dolphin Echolocation

Thursday 2:00 p.m. -2:50 p. m.

Alamo Room

**APA/SWPA Undergraduate/Graduate Student
Workshop***Chaired by Merry Bullock***Entering the Academic Marketplace: Advice from Experts
A Primer on Entering the Professoriate**Thursday 2:00 p.m.-4:00 p.m.
Ludwig's Room

What is the "right" academic job, and what does it take to land it? This workshop is designed for aspiring academics who are currently undergraduate and graduate students. Questions regarding the professoriate will be discussed. Expert panelists will share their insights, with plenty of opportunity for discussion.

Fee: This workshop is free to students, but an e-mail indicating your intent to attend must be sent to Deborah McCall at dmccall@apa.org.

SAMR Paper Session

Thursday 2:30 p.m.- 4:30 p.m.

Mahncke Room

Chaired by Charles Burdsal and Ira Bernstein

**Transforming the Traditional Classroom to a More Student-
Centered Environment in Order to Enhance the Teaching of
Undergraduate Statistics**

Charles G. Halcomb

Wichita State University

Candace N. Gilmore

*Wichita State University***Developing Proficiency in Excel, SPSS and Matrix Algebra for
Graduate Students Learning Multivariate Methods**

Charles A. Burdsal

Wichita State University

Statistics for Graduate Study in Psychology, A Whirlwind One Semester Tour

Dennis L. Jackson

University of Windsor

Use of Computer Simulation in Teaching Multivariate Methods

Ira H. Bernstein

University of Texas, Arlington

Teaching Multivariate Statistics: A Cognitive Approach

Gina M. Copas

Wichita State University

Cramming Just a Little More: Incorporating IRT and DIF into Classical Test Theory Curricula

Cayla R. Teal

*Department of Veterans Affairs and
Baylor College of Medicine, Houston*

Karon F. Cook

*Department of Veterans Affairs and
Baylor College of Medicine, Houston*

Adopting a Decision Making and Problem Solving Approach to Teaching Multivariate Methods

John E. Cornell

*Geriatric, Research, Education and Clinical
Center (GRECC) & Veterans Evidence-Based
Research, Dissemination, and Implementation
Center (Verdict), South Texas Veterans Health
Care System, San Antonio*

Belinda Gutierrez

St. Mary's University

SWPA Paper Session-Cognitive

Thursday 3:00 p.m.- 4:15 p.m.

Yellow Rose Room

Chaired by Todd Wiebers

Perspective Shifting Games and Creativity

Tyler C. Droege

Texas Christian University

Devereaux J. Branham

Texas Christian University

Tiffany L. Sia

Texas Christian University

Michael L. Czuchry

Texas Christian University

White Bears Return with No Rebounds

Carrie H. Cahal

Henderson State University

Todd Wiebers

Henderson State University

Eyewitness Identification: An Investigation of Illumination, Gender, and Exposure Effects

Scott A. Hutchens

Delta State University

Meredith Webster

Delta State University

Processing Orientation and Stimulus Specificity in Facial Recognition

Matt Carter

University of North Texas

Susan Dailey

University of North Texas

Paul L. Lambert

University of North Texas

Martin Bink

University of North Texas

Ernest H. Harrell

University of North Texas

Effects of Musical and Linguistic Emotional Congruence on Mood States

Daniel S. Glaser

Texas Lutheran University

SWPA Symposium-Effects of Ethnicity

Thursday 3:00 p.m.-4:30 p.m.

Magnolia Room

Chaired by Patricia Owen

Effects of Ethnicity, Gender Identity, and Context on Moral Orientation

Patricia Owen

St. Mary's University

Jenni M. Trager

St. Mary's University

Belinda Gutierrez

St. Mary's University

SWPA Symposium-Teaching General Psychology

Thursday 3:00 p.m.-5:00 p.m.

Bluebonnet Room

Chaired by Edward P. Kardas

New and Seasoned Chefs Meet to Toss General Psychology Salads

Edward P. Kardas

Southern Arkansas University

Chrisanne Christensen

Southern Arkansas University

Loretta N. McGregor

Ouachita Baptist University

Deborah J. Wilson

Southern Arkansas University

Beth C. Scroggins

Southern Arkansas University

Kerri K. Franks

Southern Arkansas University

SWPA/SCPA Poster Session

Thursday 3:00 p.m.-4:15 p.m.

Robert Johnson Room

Board 1: Arousal Level and Episodic Self-Wounding in a Male ChimpanzeeValerie G. James-Aldridge *University of Texas-Pan American***Board 2: Further Evaluation of a Novel Configuration of the Elevated-Plus Maze**David Hightower *West Texas A&M University*Richard D. Harland *West Texas A&M University*Debi K. Winkle *West Texas A&M University***Board 3: Pre/Postnatal Lead Exposure, Acute Caffeine, and Rats' Runway Performance**Johnathan W. Scott *Emporia State University*Glenda C. Jackson *Emporia State University*Michelle L. Dawson *Emporia State University*Cathy A. Grover *Emporia State University***Board 4: Preferences and Aversion of Feeding Places with Organic Residues**J. C. Pedro Arriagra-Ramirez *National Autonomous University of Mexico
FES Iztacala*M. Guadalupe Ortega-Saavedra *National Autonomous University of Mexico
FES Iztacala*C. Edith Juarez-Maldonado *National Autonomous University of Mexico
FES Iztacala*Francisco Huichan-Olivares *National Autonomous University of Mexico
FES Iztacala***Board 5: Habitat Use and Foraging Behavior in Captive Attwater's Prairie-Chicken (*Tympanuchus Cupido Attwateri*)**Scott Coleman *University of North Texas Health Science
Center*Janet Johnson *Fossil Rim*Roger L. Mellgren *University of Texas at Arlington*

Board 6: Conditioned Place Preference in the Ring Neck Dove

Stephanie Gleason

Sweet Briar College

Melissa Burns Cusato

Sweet Briar College & University of Virginia

Brian Cusato

Sweet Briar College

SWPA Invited Symposium-*Chaired by John Davis*
The Psychology of Hate and Terrorism

John M. Davis*Texas State University***Christopher Frost***Texas State University***Christopher Koch***George Fox University***Michael J. Stevens***Illinois State University***Robert J. Sternberg***Yale University*

Thursday 3:00 p.m.-5:00 p.m.

Crystal Ballroom

SAMR Business Meeting and Social Hour

Thursday 4:30 p.m.-5:30 p.m.

Mahncke Room

SWPA Social Hour and 50th Anniversary Celebration*(Celebration begins at 5:30)*

Thursday 5:00 p.m.-7:00 p.m.

Gunter Terrace

Friday, April 9, 2004
Past President's Day

CUPP/CTUP Invited Address - *Chaired by Fred Maxwell*

Maureen McCarthy

American Psychological Association

**Reversing the Lens: Assessing the Efficacy of
 Undergraduate Psychology Programs**

Friday 8:00 a.m.-8:50 a.m.
 Crystal Ballroom

Departments of psychology are facing increasing pressure to demonstrate student learning. Assessment of these outcomes is usually conducted through a series of measures focused on discipline specific information. This session will address the cumulative effects of the student experience.

Psi Chi Paper Session I

Friday 8:00 p.m.-9:30 p.m.

Quadrangle Room

Chaired by John Davis

**Safety Intervention Diminishes Pedestrian Jaywalking at
 Crosswalks**

Richard B. Cano

Texas State University

Catherine A. Bower

Texas State University

Work and Other Factors that Influence College Stress Levels

Aracely Arellano

Stephen F. Austin State University

Shane Davis

Stephen F. Austin State University

Kimberly Butler

Stephen F. Austin State University

Tamara Grissin

Stephen F. Austin State University

Reshaunda Strickland

Stephen F. Austin State University

The Effects of Jigsaw Technique on Hope and Anxiety

Erin M. Bolerjack	<i>Southern Nazarene University</i>
Mindy K. Brooks	<i>Southern Nazarene University</i>
Stephanie L. Lindquist	<i>Southern Nazarene University</i>
Joseph A. Reed	<i>Southern Nazarene University</i>

Do People in Relationships Feel Better?

Brittany Clark	<i>University of St. Thomas</i>
Carla Pallares	<i>University of St. Thomas</i>

Intensity of Relationships in the Prisoner's Dilemma Game

Takashi Enami	<i>Henderson State University</i>
Aneeq Ahmad	<i>Henderson State University</i>

SWPA Symposium-Teaching Evaluations

Friday 8:00 a.m.-9:50 a.m.

Bluebonnet Room

Chaired by Charles Burdsal

In the Center Ring: Teaching Evaluations - Comments vs. Ratings

Charles A. Burdsal	<i>Wichita State University</i>
Gina Copas	<i>Wichita State University</i>
Victoria A. Mosack	<i>Wichita State University</i>
Paul D. Harrison	<i>Wichita State University</i>
Carolyn Schmidt	<i>Wichita State University</i>
Deanna K. Douglas	<i>Wichita State University</i>
Shelby C. Thompson	<i>Wichita State University</i>
Mary C. Benton	<i>Wichita State University</i>
Shannon K. Riley	<i>Wichita State University</i>
Sandra L. Ranney	<i>Wichita State University</i>

SWPA Symposium-Gender and Ethnicity

Friday 8:00 a.m.-9:30 a.m.

Magnolia Room

Chaired by Jennifer R. Zwahr-Castro

The Influence of Gender and Ethnicity in Close Romantic Relationships

Jennifer R. Zwahr-Castro	<i>St. Mary's University</i>
Cristopher T. Strenth	<i>St. Mary's University</i>
Max J. McDaniel	<i>St. Mary's University</i>
Jaqulyn Speed	<i>St. Mary's University</i>

SWPA Social and Personality Poster Session II

Friday 8:00 a.m.-9:15 a.m.

Robert Johnson Room

Board 1: Violent Video Games and Aggressive Behavior: The Weakest Link?

Carl W. Scott	<i>University of St. Thomas</i>
---------------	---------------------------------

Board 2: Impact of Experimenter Attire and Sex on Participant Productivity

Raymond J. Green	<i>Texas A&M-Commerce</i>
Jana C. Sandall	<i>Texas A&M-Commerce</i>

Board 3: Humor and Hindsight Bias

Harry L Hom, Jr.	<i>Southwest Missouri State University</i>
------------------	--

Board 4: Hindsight Bias: Effects of Present Knowledge Source

Michelle Chang	<i>Trinity University</i>
Meghan Pollard	<i>Trinity University</i>
Stephany Gordon	<i>Trinity University</i>
Harry M. Wallace	<i>Trinity University</i>

Board 5: Optimists Solve Problems Successfully: A Study of Social Dilemmas

Amy Dicke Bohmann	<i>Texas Lutheran University</i>
Brianna L. Yarborough	<i>Texas Lutheran University</i>

Board 6: Optimism and First Impressions

Lori A. Stewart	<i>Texas Lutheran University</i>
-----------------	----------------------------------

Board 7: College Students' Perceptions and Ratings of Their Stress

Bernadette M. Gadzella	<i>Texas A&M-Commerce</i>
James R. Stacks	<i>Texas A&M-Commerce</i>
Virginia K. Thompson	<i>Texas A&M-Commerce</i>

Board 8: Willingness to Use Race as a Social Category

Beth A. Hentges	<i>University of Houston-Clear Lake</i>
Cynthia L. Campbell	<i>University of Houston-Clear Lake</i>
Sheri Y. Kelley	<i>University of Houston-Clear Lake</i>
Jhenna S. Men	<i>University of Houston-Clear Lake</i>
Jaime N. Peoples	<i>University of Houston-Clear Lake</i>
Nova R. Beltran	<i>University of Houston-Clear Lake</i>

Board 9: The Media's Effect on the Judgment of Physical Attractiveness

Jacqi S. Towsley	<i>Midwestern State University</i>
------------------	------------------------------------

Board 10: Balancing Balance Theory

Jason K. Ouellette	<i>Midwestern State University</i>
Jacqueline L. Cuevas	<i>Midwestern State University</i>

Board 11: Relationships between Facial Attractiveness and Mental Health Ratings

Jaime Wood	<i>University of Louisiana-Monroe</i>
Mary Ann Goodwyn	<i>University of Louisiana-Monroe</i>
Jean M. Low	<i>University of Louisiana-Monroe</i>
B. Jean Cottingham	<i>University of Louisiana-Monroe</i>

Board 12: Should Trent Lott Have Been Forced to Resign His U.S. Senate Seat?

Katrina E. Bedell	<i>University of Oklahoma at Norman</i>
Paul R. Nail	<i>Southwestern Oklahoma State University</i>

Board 13: Relationships between Religiosity, Attachment Styles, and Sexual Behaviors Among Females

Alexandra Z. Canales	<i>St. Mary's University</i>
----------------------	------------------------------

Board 14: Instructional Control in the Prisoner's Dilemma

Todd A. Ward	<i>Stephen F. Austin State University</i>
Bryan K. Saville	<i>Stephen F. Austin State University</i>

Board 15: Heuristics Utilized in Columbia Explosion: Salience Versus Quantity

Sarah A. Crossett	<i>Williams Baptist College</i>
Amanda Jo Clark	<i>Williams Baptist College</i>
Terri L. Evans	<i>Williams Baptist College</i>

Board 16: Creation of an Alarmism Scale

Amy Dicke Bohmann	<i>Texas Lutheran University</i>
Rachel G. Belmarez	<i>Texas Lutheran University</i>
Chelsea N. Ball	<i>Texas Lutheran University</i>

Board 17: Self-Presentation Aspects of the Imposter Phenomenon

Randall D. Wight	<i>Ouachita Baptist University</i>
Loretta N. McGregor	<i>Ouachita Baptist University</i>
Courtnie D. Ortiz	<i>Ouachita Baptist University</i>
Emily N. Griggs	<i>Ouachita Baptist University</i>
Damon Gee	<i>University of Arkansas at Little Rock</i>

Board 18: Cross-Sex Friendships: Attitudes, Beliefs, and Attributional Process

Twila S. Owens	<i>University of Arkansas at Fayetteville</i>
Nathan L. Williams	<i>University of Arkansas at Fayetteville</i>

Board 19: Modern Electronic Communication and Attachment Theory: Does Attachment Predict Use?

Chad Parsons	<i>University of Arkansas at Fayetteville</i>
John M. Reardon	<i>University of Arkansas at Fayetteville</i>
Nathan L. Williams	<i>University of Arkansas at Fayetteville</i>

Board 20: American Sign Language, Fingerspelling, and Anxiety

Stephanie A. Sween	<i>Texas A&M System Center at San Antonio</i>
Gary F. Coulton	<i>Texas A&M System Center at San Antonio</i>

Board 21: Self-Esteem and Socioeconomic Status in Rural Women: Longitudinal Analyses

Carol L. Bennett	<i>University of North Dakota</i>
Russell L. Bennett	<i>Bemidji State University</i>
James M. Rafferty	<i>Bemidji State University</i>

Board 22: The Relationship Between Type of Sorority and Self-Esteem in College Females

Achlie N. Nix

Stephen F. Austin State University

Bryan K. Saville

*Stephen F. Austin State University***Board 23: Toward an Interpersonal Expectancy Scale**

Robert D. Mather

Texas Tech University

Mario P. Casa de Calvo

Texas Tech University

Darcy A. Reich

*Texas Tech University***Board 24: The Ego State Questionnaire-Revised**

Donald A. Loffredo

University of Houston-Victoria

Rick Harrington

*University of Houston-Victoria***Board 25: An Examination of Expectancies and Goals for Dispositional Inferences**

Robert D. Mather

Texas Tech University

Darcy A. Reich

*Texas Tech University***Board 26: Effects of Personal Attributes and Controllability of Traits on Perceptions of Attractiveness**

Robin E. White

*Texas Lutheran University***Board 27: Measuring Self-Beliefs: Actual and Perceived Self**

Stephanie G. Duran

*Midwestern State University***Board 28: The Color Yellow and Its Effects on Students' Future Expectancies**

Kelly J. Kirkpatrick

Midwestern State University

Jacqueline L. Cuevas

Midwestern State University

SWPA Continuing Education Workshop**Robert L. Mapou***Independent Practice, Silver Springs, MD***Assessment of Learning Disabilities and
Attention/Deficit-Hyperactivity Disorder in Adults**Friday 8:30 a.m.- 4:30 a.m.
Mahncke Room

This INTERMEDIATE workshop will describe strategies for the assessment of developmental learning disorders in adults. Participants will learn about recent research on these disorders, characteristics of learning disability sub-types, and evaluation methods. The latter will include key historical factors, a cognitive framework for assessment and specific checklists and tests. Additional topics will include documentation requirements of colleges and universities, accommodations and interventions for college students with learning disorders, and accommodations and interventions for those in the workplace. Applications will be illustrated with detailed case examples.

Fee: \$140 for SWPA Members/\$175 for nonmembers
Seven hours of Continuing Professional Education Credit

SWPA Invited Symposium

Chaired by Stephen F. Davis and Randall D. Wight

**Looking Backwards, Looking Forward, Taking Stock:
A Session on the History of SWPA**

Stephen F. Davis *Emporia State University*
Randall D. Wight *Ouachita Baptist University*
Scott A. Bailey *Texas Lutheran University*
Tracy Zinn *Stephen F. Austin State University*

Friday 9:00 a.m.-10:50 a.m.
Crystal Ballroom

**SWPA Symposium-Laboratory Behavioral Measures
of Impulsivity**

Friday 9:00 a.m.- 11:00 a.m.

Baker Room

Chaired by Donald Bougherty

Introduction to Laboratory Behavioral Measures of Impulsivity

Donald M. Dougherty	<i>University of Texas at Houston</i>
David Trotter	<i>University of Texas at Houston</i>
Ashley Jagar	<i>University of Texas at Houston</i>
Lauren M. Kirshbaum	<i>University of Texas at Houston</i>
Camelia Matthews	<i>University of Texas at Houston</i>

TOPSS/SWPA Workshop

**Getting to Know Psychology: Tips for Promoting
Psychology Awareness in the Classroom, the School
and the Community**

Marissa Saranbando *Memorial High School
McAllen, TX*

Margaret Davidson *Berkner High School
Richardson, TX*

Friday 9:00 a.m.-11:00 a.m.
Alamo Room

SCPA Paper Session III

Friday 9:00 a.m.-11:00 a.m.

Frontier Room

Chaired by Steven J. Schapiro

The Neurobiology of Paced Mating Behavior in the Female Rat

Fay A. Guarraci *Southwestern University*

**Empirical and Functional Analyses of Trills in Male Weddell
Seals**

Jesse E. Purdy *Southwestern University*

Nicole Buehler *Southwestern University*

Sheralyn Chilson *Southwestern University*

Resource Utilization in a Case Management Intervention for Low-Income Uninsured

Ruth Wetta-Hall

Wichita State University

Elizabeth Ablah

Wichita State University

Cognitive Ethology: An Oxymoron, Something Trendy, Retro, or Progressive?

Lani P. Lyman-Henley

Tracy B. Henley

Texas A&M-Commerce

Chemical Prey Preferences of Juvenile and Adult Wandering Garter Snakes

Lani P. Lyman-Henley

SWPA Human Factors, Industrial/Organizational, and Computer Technology Poster Session

Friday 9:30 a.m.-10:45 a.m.

Robert Johnson Room

Board 1: Applied Psychophysics I: Idiosyncratic Number in Glaucomatous Optic Disc Assessment

Anthony D. Realini

West Virginia University Eye Institute

Steven B. Flynn

Louisiana State University

Health Sciences Center

John B. Pittenger

University of Arkansas at Little Rock

Board 2: Applied Psychophysics II: Order Effects in Glaucomatous Optic Disc Assessment

Steven B. Flynn

Louisiana State University

Health Sciences Center

Anthony D. Realini

West Virginia University Eye Institute

John B. Pittenger

University of Arkansas at Little Rock

Joe McGahan

University of Louisiana-Monroe

Board 3: Influence of Case, Emphasis and Motivation on Readability and Retention

Lauren Scharff	<i>Stephen F. Austin State University</i>
Sarah E. Greer	<i>Stephen F. Austin State University</i>
Jeffrey L. Oldenkamp	<i>Stephen F. Austin State University</i>
Ugochi U. Onyejiaka	<i>Stephen F. Austin State University</i>
Taylor A. Sloan	<i>Stephen F. Austin State University</i>
Todd A. Ward	<i>Stephen F. Austin State University</i>

Board 4: Effects of Smiling and Feedback on Task Performance and Target Self Esteem

Dale O. Jorgenson	<i>California State University, Long Beach</i>
-------------------	--

Board 5: Job/Career Change and Job Satisfaction of University Employees

Sangeeta Singg	<i>Angelo State University</i>
Crystal N. Mata	<i>Angelo State University</i>
Robert C. Oliver	<i>Angelo State University</i>
Marc D. Brown	<i>Angelo State University</i>

Board 7: Interaction between Employment, Health, and Academic Performance in Hispanic Undergraduates

Melanie A. Peralez	<i>University of Texas-Pan American</i>
Iliana M. Perez	<i>University of Texas-Pan American</i>
Mirella Roman Martinez	<i>University of Texas-Pan American</i>
Monica B. Pinalez	<i>University of Texas-Pan American</i>
Jerry Gomez	<i>University of Texas-Pan American</i>
Kristin L. Croyle	<i>University of Texas-Pan American</i>

Board 6: Physical Attractiveness as a Determinant of Perceived Competence

Melinda Burgess	<i>Southwestern Oklahoma State University</i>
-----------------	---

Board 8: Social Desirability and Reported Sales Productivity in an International Small Sample

Trelitha R. Bryant	<i>Behavioral Sciences Research Press</i>
George Dudley	<i>Behavioral Sciences Research Press</i>

Board 9: Employer Attribution and Bias Towards Mentally Ill Employees

Grant S. Goodale *University of Central Oklahoma*
Kathleen M. Donovan *University of Central Oklahoma*

Board 10: Adults with Suicide Attempts: Continuous Performance Testing

Camelia Matthews *University of Texas at Houston*
Charles W. Mathias *University of Texas at Houston*

Board 11: Integrated Visual and Audio Continuous Performance Test with Undergraduate Students

Tricia Kramer *Sam Houston State University*
Marsha J. Harman *Sam Houston State University*
A. Jerry Bruce *Sam Houston State University*
Christopher Wilson *Sam Houston State University*

Board 12: Inferential Accuracy and Characteristics of Dyadic, Online Interactions

Stella D. Garcia-Lopez *University of Texas at San Antonio*

Board 13: State Self-Esteem, Frustration and Perceived Task Performance

Deborah Oem *Angelo State University*
Kraig Schell *Angelo State University*
Kurtis R Neal *Angelo State University*

SWPA Paper Session- Social and Developmental

Friday 10:00 a.m.- 11:15 a.m.

Magnolia Room

Chaired by Daniel K. Festa

The Role of Social Identity and Personality and Dealing with Cultural Diversity in Teams

Karen I van der Zee

Medical Residents' Beliefs and Attitudes Regarding Obesity

Elizabeth Ablah *Wichita State University*
Ruth Wetta-Hall *Wichita State University*
Charles A. Burdsal *Wichita State University*

College Students Responses to Sudden Traumatic Death

Jennifer D. Ryburn

Henderson State University

Daniel K. Festa

*Henderson State University***Aggressive Driving and Personality: Who Gets Angry and When**

William S. Rogers

*McMurry University***Alcohol Awareness Program Curbing Students from Drug and Alcohol Consumption**

Jack Birchfield

Tarleton State University

Bridget M. Talmage

Tarleton State University

Jeannie L. Howard

Tarleton State University

Cheryl Beeler

Tarleton State University

Thomas Dougherty

*Tarleton State University***SWPA Invited Address**-Chaired by Edward P. Kardas**Robert J. Sternberg***Yale University***Culture and Intelligence**

11:00 a.m.-11:50 a.m.

Crystal Ballroom

Intelligence cannot be fully understood outside its cultural context. Attempts to devise tests that measure intelligence anywhere at any time are unrealistic and counterproductive, providing misleading information about the candidates who are tested. Dr. Sternberg will describe multicultural and cross-cultural work that illustrates the extent to which intelligence is culturally defined.

Psi Chi Paper Session II

Friday 12:00 p.m.-1:30 p.m.

Frontier Room

Chaired by Lauren Scharff

Effects of Persuasive Narratives on Peer Pressure Influence

Dalila B. Lara

*McMurry University***The Effect of Cartoon Violence on Children's Aggressive Behaviors**

Alicia Pierce

Henderson State University

Aneeq Ahmad

*Henderson State University***Drinking and Driving: Changing Attitudes in High-Risk Youth**

Cassie Thompson

Henderson State University

Todd Wiebers

*Henderson State University***Effects of Two Types of Music**

Nicole A. Truxillo

University of St. Thomas

Carl Castoreno

*University of St. Thomas***Survival of the White Chickens Redux**

Bette' L. Volland

Henderson State University

Todd Wiebers

*Henderson State University***SWPA Culture, Gender, and Ethnicity Poster Session**

Friday 12:00 p.m.-1:15 p.m.

Robert Johnson Room

Board 1: Internationalizing the Psychology Curriculum: Resources for Teachers

John M. Davis

Southwest Texas State University

Catherine A. Bower

*Southwest Texas State University***Board 2: Mood and Somatic Symptoms Differ by Level of Hispanic Acculturation**

Mirella Roman Martinez

University of Texas-Pan American

Monica B. Pinalez

University of Texas-Pan American

Iliana M. Perez

University of Texas-Pan American

Melanie A. Peralez

University of Texas-Pan American

Jerry Gomez

University of Texas-Pan American

Kristin L. Croyle

University of Texas-Pan American

Board 3: Acculturation, Familism and Beliefs About Memory in Aging

Chavonne A. Long	<i>Texas Tech University</i>
Ricardo A. Ramirez	<i>Texas Tech University</i>
Laura Cruz Garza	<i>Texas Tech University</i>
M. Kathryn Bleckley	<i>Texas Tech University</i>

Board 4: Validation of the Multicultural Perspective Index (MPI)

Robert Mowrer	<i>Angelo State University</i>
---------------	--------------------------------

Board 5: Do Hispanics Show Stereotype Threat Effects on Mental Ability Tests?

Luis O. Rivera	<i>University of Texas at San Antonio</i>
Myriam Lopez	<i>University of Texas at San Antonio</i>
Bernardino Hernandez	<i>University of Texas at San Antonio</i>
Thomas R. Coyle	<i>University of Texas at San Antonio</i>

Board 6: Stereotype Threat in Average and Invested Students

Stephen R. Burgess	<i>Southwestern Oklahoma State University</i>
Tabatha H. Smith	<i>Southwestern Oklahoma State University</i>

Board 7: The Effect of Media Portrayals on Women's Body Image

Melinda Burgess	<i>Southwestern Oklahoma State University</i>
-----------------	---

Board 8: The Role of Gender in Memory

Shelia M. Kennison	<i>Oklahoma State University</i>
Benjamin A. Porter	<i>Oklahoma State University</i>

Board 9: Dexter not Dee Dee: Stereotypic Perceptions of Scientists

Tracy B. Henley	<i>Texas A&M-Commerce</i>
Mark D. Thomas	<i>Mississippi State University</i>

Board 10: The Sensory Sensitivity Scale: Sex and Population Differences

Grant Benham	<i>University of Texas-Pan American</i>
--------------	---

Board 11: Attachment and Severity of Female Intimacy Violence

Ashley D. Barnes	<i>Texas A&M-College Station</i>
David Lawson	<i>Texas A&M-College Station</i>
Jeanette P. Madkins	<i>Texas A&M-College Station</i>

**Board 12: Beliefs about the Psychology of Menstruation:
1870-1945**

Kristal Key	<i>Texas A&M-College Station</i>
Monique Ziebro	<i>Texas A&M-College Station</i>
Anne Hargrove	<i>Texas A&M-College Station</i>

Board 13: Dual Stigmatization in Leadership Evaluations

Brandy L. Stiles	<i>Sam Houston State University</i>
Donna M. Desforjes	<i>Sam Houston State University</i>

**Board 14: Attitudes Toward Housecleaning in an Adult
Workforce Sample**

Victoria Vickers	<i>Texas State University</i>
Shirley M. Ogletree	<i>Texas State University</i>
G. Marc Turner	<i>Texas State University</i>

**Board 15: Attitudes Toward Housecleaning: Testing a
Four-Factor Scale**

Shirley M. Ogletree	<i>Texas State University</i>
G. Marc Turner	<i>Texas State University</i>
Ana C. Vieira	<i>Texas State University</i>
Joshua M. Brunotte	<i>Texas State University</i>

**Board 16: Evaluation of a Sexual Assault Prevention Program
Targeting Male Youth**

Mirna F. Loya	<i>Washburn University of Topeka</i>
Amie M. Idol	<i>Washburn University of Topeka</i>
Dave L. Provorse	<i>Washburn University of Topeka</i>

**Board 17: Sexuality Issues: A Religion-Affiliated University
Versus A Secular University.**

Michael D. Murphy	<i>Ouachita Baptist University</i>
-------------------	------------------------------------

**Board 18: Body Image as Predicted by Perfectionism,
Obsessive Compulsiveness, and Assertiveness**

Kathleen A. Younger	<i>University of Louisiana-Monroe</i>
Veronica E. Lewis	<i>University of Louisiana-Monroe</i>
B. Jean Cottingham	<i>University of Louisiana-Monroe</i>

Board 19: Sex, Social Support, and College Satisfaction in Hispanic Undergraduates

Iliana M. Perez	<i>University of Texas-Pan American</i>
Jerry Gomez	<i>University of Texas-Pan American</i>
Monica B. Pinalez	<i>University of Texas-Pan American</i>
Mirella Roman Martinez	<i>University of Texas-Pan American</i>
Melanie A. Peralez	<i>University of Texas-Pan American</i>
Kristin L. Croyle	<i>University of Texas-Pan American</i>

Board 20: Gender-Linked Differences in Written Language: A Gender-Schema Approach

Donna A. Crowley	<i>Texas A&M-Commerce</i>
------------------	-------------------------------

Board 21: Differences in Self-Disclosure by Race, Socioeconomic Status, and Gender

Quinessa Johnson	<i>University of Louisiana-Monroe</i>
Veronica E. Lewis	<i>University of Louisiana-Monroe</i>
Mary Ann Goodwyn	<i>University of Louisiana-Monroe</i>

Board 22: Mexican American and Caucasian University Students' Experience of Sexual Harassment

Lisa K. Kearney	<i>University of Texas at Austin</i>
-----------------	--------------------------------------

Board 23: Ethnic Difference in Elderly Attitudes Toward Mental Health Care

Paula J. Biedenharn	<i>Texas A&M-Corpus Christi</i>
Steven D. Seidel	<i>Texas A&M-Corpus Christi</i>
Mark Hartlaub	<i>Texas A&M-Corpus Christi</i>
Pamela Brouillard	<i>Texas A&M-Corpus Christi</i>
Heather C. Moeller	<i>Texas A&M-Corpus Christi</i>
Christina Garcia	<i>Texas A&M-Corpus Christi</i>
Michelle M. Valdez	<i>Texas A&M-Corpus Christi</i>
Stephanie K. Garrett	<i>Texas A&M-Corpus Christi</i>
Kara L. Fregia	<i>Texas A&M-Corpus Christi</i>

Board 24: Integration, In-Group Rejection, Stress, and Racelessness in African Americans

Gerald W. Ritter	<i>Alcorn State University</i>
Jared Prentiss	<i>Alcorn State University</i>
Christopher Sullivan	<i>Alcorn State University</i>
Lalita Pathak	<i>Alcorn State University</i>

Board 25: Structure Analysis of the Weiss-Lyon Scale

David Weissenburger	<i>Tarleton State University</i>
---------------------	----------------------------------

Board 26: Successful Techniques Implemented in a University Race Relations Class

Peter L. Kranz	<i>University of Texas-Pan American</i>
----------------	---

Board 27: The Severity of Punishment Based on Race

Patricia Truhn	<i>Midwestern State University</i>
----------------	------------------------------------

APA/SWPA Distinguished Scientist Lecture-*Chaired by Mary Brazier*

John Gabrieli

Stanford University

How the Human Brain Regulates Thoughts, Feelings, and Memories: Evidence from Functional Neuroimaging

Friday 1:00 p.m.-1:50 a.m. Crystal Ballroom

SWPA Symposium-Clinical Research and Practice

Friday 1:00 p.m.- 3:00 p.m.

Bluebonnet

Chaired by Scott Perkins

Current Directions in Clinical Research and Practice

Scott Perkins	<i>Abilene Christian University</i>
Jamey Crosby	<i>Abilene Christian University</i>
Melissa Stoddard	<i>Abilene Christian University</i>
Megan Karcher	<i>Abilene Christian University</i>
Bre Robertson	<i>Abilene Christian University</i>
Allison Gervais	<i>Abilene Christian University</i>
Adam Looney	<i>Abilene Christian University</i>

SCPA Invited Address-*Chaired by Ronald Taylor*

A. M. Prestrude

Virginia Polytechnic Institute and State University & Galaxy Scientific Corporation

**Selection, Training, and Testing of
Canine-Human Teams for Hazardous Materials Detection**

Friday 1:00 p.m.-1:50 p.m.
Alamo Room

SWPA Clinical and Counseling Poster Session

Friday 1:00 p.m.-2:15 p.m.

Robert Johnson Room

Board 1: Self-Disclosure as a Pathway to Happiness

Vanessa Avina

St. Mary's University

**Board 2: Differential Diagnosis and Incidence of Sales Call
Reluctance**

George Dudley

Behavioral Sciences Research Press

Larry Chonko

Baylor University

John F. Tanner

Baylor University

**Board 3: Increasing Exposure Willingness in an Analog Study:
Utilizing Patient Testimonials**

Theresa H. Fesperman

Trinity University

Claire K. Allan

Trinity University

Carolyn B. Becker

Trinity University

Ashley J. Girgis

Trinity University

**Board 4: Stages of Change and Psychological Well Being:
A Preliminary Investigation**

Rick Harrington	<i>University of Houston-Victoria</i>
Donald A. Loffredo	<i>University of Houston-Victoria</i>
Catherine A. Perez	<i>University of Houston-Victoria</i>
Laura R. Knowles	<i>University of Houston-Victoria</i>
Michael K. Ligoeki	<i>University of Houston-Victoria</i>

**Board 5: Help-Seeking Profiles of Minority Females in a
National Sample**

Tazim S. Merchant	<i>St. Mary's University</i>
Tamara S. Bustamante	<i>St. Mary's University</i>
Andrea E. Berndt	<i>St. Mary's University</i>

**Board 6: Worry and Cognitive Vulnerability to Anxiety:
A Mentation Sampling Study**

Tisha L. McDonald	<i>University of Arkansas at Fayetteville</i>
Nathan L. Williams	<i>University of Arkansas at Fayetteville</i>

**Board 7: Hypnosis in Therapeutic Settings: A Pilot Survey of
Professional Attitudes**

Angela M. Morrone	<i>St. Edward's University</i>
Sarah E. Henseler	<i>St. Edward's University</i>

**Board 8: Test-Retest Reliability of an Instrument to Assess
ADHD Attitudes**

David R. Pillow	<i>University of Texas at San Antonio</i>
Dorothy A. Flannagan	<i>University of Texas at San Antonio</i>
Rochelle L. Sherrill	<i>University of Texas at San Antonio</i>
Karen E. Spence	<i>University of Texas at San Antonio</i>
Leslie L. Thayer-Coleman	<i>University of Texas at San Antonio</i>

**Board 9: Emotional Writing and the Event Itself: Does Timing
Matter?**

Jigna V. Ragha-Cooper	<i>University of Houston-Clear Lake</i>
Amy K. Milkavich	<i>University of Houston-Clear Lake</i>
Jo A. Meier	<i>University of Houston-Clear Lake</i>

Board 10: Vulnerabilities to Emotional Disorders in Female Sexual Abuse Survivors

Heather L. Renfroe	<i>University of Arkansas at Fayetteville</i>
Lisa Elwood	<i>University of Arkansas at Fayetteville</i>
Nathan L. Williams	<i>University of Arkansas at Fayetteville</i>
Nathan L. Williams	<i>University of Arkansas at Fayetteville</i>

Board 11: Student Attitudes Toward Seeking Psychological Help

Steven D. Seidel	<i>Texas A&M-Corpus Christi</i>
Mark Hartlaub	<i>Texas A&M-Corpus Christi</i>
Pamela Brouillard	<i>Texas A&M-Corpus Christi</i>
Paula J. Biedenharn	<i>Texas A&M-Corpus Christi</i>
Kara L. Fregia	<i>Texas A&M-Corpus Christi</i>
Stephanie K. Garrett	<i>Texas A&M-Corpus Christi</i>
Heather C. Moeller	<i>Texas A&M-Corpus Christi</i>
Michelle M. Valdez	<i>Texas A&M-Corpus Christi</i>
Christina Garcia	<i>Texas A&M-Corpus Christi</i>

Board 12: Situational Correlates of Disclosure of Child Sexual Abuse

Elizabeth S. Wiley	<i>Texas A&M-College Station</i>
--------------------	--------------------------------------

SWPA Symposium-Writing Research

Friday 1:00 p.m.- 2:30 p.m.

Yellow Rose Room

Chaired by Arnold Froese

Teaching Students to Write Research Papers

Arnold D. Froese	<i>Sterling College</i>
Bill J. Lammers	<i>University of Central Arkansas</i>
Mukul Bhalla	<i>Loyola University New Orleans</i>

SWPA Invited Symposium

Best Practices for Teaching Introductory Statistics

Chris Spatz

Hendrix College

Roger E. Kirk

Baylor University

Dave Howell

University of Vermont

Friday 2:00 p.m.-3:30 p.m.

Magnolia Room

Psi Chi Invited Speaker-Chaired by John Davis

Jesse E. Purdy

Southwestern University

**The Future and Promise of Psi Chi:
The National Honor Society in Psychology**

Friday 2:00 p.m.-2:50 p.m.

Crystal Ballroom

SWPA Paper Session-Experimental and Learning

Friday 2:00 p.m.-3:15 p.m.

Baker Room

Chaired by James Kopp

**Response Duration During Differential Reinforcement Using
Three Shaping Algorithms**

Denise L. Arellano

University of Texas at Arlington

James L. Kopp

University of Texas at Arlington

The Effect of Strategy on Time Estimation

Scott W. Johnson

Lamar University

Joanne S. Lindoerfer

Lamar University

Interest's Impact on Reading Comprehension

Jill M. Townsend

Midwestern State University

CTUP Invited Address-*Chaired by Heidi Ziemer*

Lauren Scharff

Stephen F. Austin State University

Fighting Burnout: Making Your Job Fulfilling and Fun

Friday 2:00 p.m.-2:50 p.m.
Yellow Rose Room

Too often it's easy to get stuck in teaching ruts and feel burdened with grading, committee work, advising, etc. However, there are strategies both inside and outside the classroom that may help you regain or increase your enthusiasm for teaching and for your job as a whole. Come listen to and share ideas!

SCPA Invited Address-*Chaired by Melissa Burns Cusato*

Sheree Watson

University of Southern Mississippi

Is Curiosity the Engine of Intellect? An Examination of Temperament and Problem Solving in Garnett's Bushbaby

Friday 2:00 p.m.-2:50 p.m.
Alamo Room

SWPA Symposium-Freud

Friday 2:00 p.m.-3:30 p.m.

Frontier Room

Chaired by Richard A. Beck

Freud's Scalpel: Defensive Versus Existential Religion

Richard A. Beck	<i>Abilene Christian University</i>
David Pittman	<i>Abilene Christian University</i>
Travis Grow	<i>Abilene Christian University</i>
Joel Rodriquez	<i>Abilene Christian University</i>
Cynthia Bedgood	<i>Abilene Christian University</i>
Allison Gervais	<i>Abilene Christian University</i>
Trevor Rose	<i>Abilene Christian University</i>
Erin Kelley	<i>Abilene Christian University</i>
Dawn Fultz	<i>Abilene Christian University</i>
Trisha Williams	<i>Abilene Christian University</i>
Jonathan Wade	<i>Abilene Christian University</i>
Bethany Scroggins	<i>Abilene Christian University</i>
Jennifer Voiles	<i>Abilene Christian University</i>
Jill Rowland	<i>Abilene Christian University</i>
Kristen Parker	<i>Abilene Christian University</i>

SWPA Behavioral Science Poster Session

Friday 2:30 p.m.-3:45 p.m.

Robert Johnson Room

Board 1: The Highly Sensitive Person: Perceived Stress, and Physical Health ComplaintsGrant Benham *University of Texas-Pan American***Board 2: Visual and Auditory Arousal Measured by GSR, EEG, and Heart Rate**Sherry Berg *DeVry University***Board 3: Neuropsychological Assessment of Chemical Poisoning Utilizing the L-NNB**

Susan B. Blake	<i>McNeese State University</i>
Lawrence S. Dilks	<i>McNeese State University</i>
Dena L. Matzenbacher	<i>McNeese State University</i>
Carolyn S. Davis	<i>McNeese State University</i>
Lauren M. Christianson	<i>McNeese State University</i>

Board 4: Heart Rate Monitoring During an Anger Inducing Task

Jean M. Low	<i>University of Louisiana-Monroe</i>
Erin L. McGahan	<i>University of Louisiana-Monroe</i>
Walonda S. Wallace	<i>University of Louisiana-Monroe</i>
Rukiya N. Canfield	<i>University of Louisiana-Monroe</i>
Christine T. Murphy	<i>University of Louisiana-Monroe</i>

Board 5: Cancer, Stress, and Exposure to Television News

Mary Ellen McNaughton-Cassill	<i>University of Texas at San Antonio</i>
Troy E. Golding	<i>University of Texas at San Antonio</i>
Kimberly Rogers	<i>University of Texas at San Antonio</i>
Criselda G. Rivas	<i>University of Texas at San Antonio</i>
Michael B. Cleveland	<i>University of Texas at San Antonio</i>
William W. Landrum	<i>University of Texas at San Antonio</i>

Board 6: The Influence of Coping and Anger on Well-Being

Jason D. Pretzel	<i>Middle Tennessee State University</i>
William C. Compton	<i>Middle Tennessee State University</i>

Board 7: Stress, the News Media, and the War in Iraq

Mary Ellen McNaughton-Cassill	<i>University of Texas at San Antonio</i>
Anthony O. Wells	<i>University of Texas at San Antonio</i>
Jodie L. Willeford	<i>University of Texas at San Antonio</i>
Kimberly Rogers	<i>University of Texas at San Antonio</i>
Janelle Carson	<i>University of Texas at San Antonio</i>
Angela A. Long	<i>University of Texas at San Antonio</i>
Michael R. Goldsmith	<i>University of Texas at San Antonio</i>

Board 8: A Case Study Involving Organic Solvent Toxicology

Lauren M. Christianson	<i>McNeese State University</i>
Carolyn S. Davis	<i>McNeese State University</i>
Lawrence S. Dilks	<i>McNeese State University</i>
Dena L. Matzenbacher	<i>McNeese State University</i>

Board 9: Personal Beliefs Regarding Using Stimulant Medication to Treat ADHD

David R. Pillow	<i>University of Texas at San Antonio</i>
Dorothy A. Flannagan	<i>University of Texas at San Antonio</i>
Karen E. Spence	<i>University of Texas at San Antonio</i>

Board 10: Endogenous Opioid Activity, Family Environment and Familial Alcoholism

Deborah Mangold

University of Texas at San Antonio

Marcia M. Jovel

University of Texas at San Antonio

Stephanie M. Garcia

University of Texas at San Antonio

Board 11: Deficits in Adaptive Behavior Secondary to Ethelene Dichloride Exposure

Christina M. Sparks

McNeese State University

Brooke D. Mayeaux

McNeese State University

Janice C. Marceaux

McNeese State University

Lawrence S. Dilks

McNeese State University

Board 12: Enhancing Usefulness of Psychological Testing for Addiction Treatment Providers

William G. McCown

University of Louisiana-Monroe

SWPA Invited Address-Chaired by Kenneth A. Weaver

Joshua Aronson

New York University

Stereotype Threat and Academic Achievement

Friday 3:00 p.m.-3:50 a.m.

Crystal Ballroom

Human intelligence is more fragile than we tend to think. It is fragile because it is transacted within a web of social relations, which are themselves often fragile. In this talk Dr. Aronson will discuss one social force that undermines people's academic achievement— stereotypes alleging the intellectual ability of certain minorities. Such stereotypes often create an atmosphere of threat, mistrust, and low expectations, and in this atmosphere, academic achievement of minorities is often undermined. In this talk Dr. Aronson will discuss research on "stereotype threat," and show how it explains part of the achievement gap between minorities and whites. Dr. Aronson will also discuss research that shows us how to help students at risk for underperformance.

SCPA Business Meeting

Friday 3:00 p.m.- 4:00 p.m.

Alamo Room

Chaired by Charles W. Hennig

SWPA Presidential Address-*Chaired by Mary Brazier*

Kenneth A. Weaver

Emporia State University

**Flexibility Inside the Vise:
High School Psychology and State Certification**

Friday 4:00 p.m.- 5:00 a.m.

Crystal Ballroom

Although psychology has been a part of the high school curriculum for the past 170 years, the last decade has witnessed significant advances in strengthening high school teachers' content knowledge, increasing the scientific rigor of the course, and building partnerships between high school and college faculty. In contrast, efforts to certify high school teachers in psychology lag. This presentation elaborates the issues and concludes with recommendations.

SWPA Business Meeting

Friday 5:15 p.m.- 6:15 p.m.

Chaired by Kenneth A. Weaver

Saturday, April 10, 2004

SWPA Continuing Education Workshop

Mary A. Connell

Independent Practice, Fort Worth, TX

**Sexual Abuse Allegations in Disputed Custody Cases:
Clinical and Forensic Considerations**

Saturday 8:30 a.m.-12:30 a.m.
Mahncke Room

The parent suspecting sexual abuse presents the child for psychotherapy, describing symptoms thought to indicate the child may have been abused. A therapist, unaware of relevant developmental and forensic literature, allies with the parent to obtain an "outry." In court, however, the case may be weakened by the therapist's actions. This INTERMEDIATE workshop will address "non-forensic" treatment needs; comprehensive forensic assessment; different roles of therapist and evaluator, consequent differences in input to the legal forum, and rules of evidence guiding testimony.

Fee: \$80 for SWPA members/ \$100 for nonmembers
Four hours of Continuing Professional Education Credit

SWPA Symposium-Qualitative Research

Saturday 8:00 a.m.-10:00 a.m. Magnolia Room

Chaired by Amy M. Fisher-Smith

Qualitative Research and Science: A Symposium

Amy M. Fisher-Smith	<i>University of Dallas</i>
Gilbert J. Garza	<i>University of Dallas</i>
Katherine A. Loufus	<i>University of Dallas</i>
Andrew J. Parker	<i>University of Dallas</i>
Greg L. Shrader	<i>University of Dallas</i>
Meroudjie Denis	<i>University of Texas at Arlington</i>

APA Undergraduate/Graduate Student Workshop

William E. Pate II

American Psychological Association

Get the Facts on Careers and Opportunities in Psychology

Saturday 8:00 a.m.-8:50 a.m.
Bluebonnet Room

PT@CC/Psi Beta Panel Discussion

*Chaired by Jennifer L. O'Loughlin-Brooks, Valerie Smith, and Ken Cowle
Collin County Community College and Navarro College*

**Engaging Community College Students
in Psychology Research**

Bree Barton

Michael Coder

Jeff Fortney

Ricky Lummus

Jessica Shreve

Brian Zadorozny

Marissa Bridgman

Lisa Dunshee

Matt Heaviside

Kimberly Nga Tanuvasa

Linda White

Saturday 8:00 a.m.-8:50 a.m.
Alamo Room

SWPA Cognition, Memory, and Learning Poster Session

Saturday 9:30 a.m.-10:45 a.m. Robert Johnson Room

Board 1: The Role of Phonological Sensitivity in Letter Knowledge Training with Children

Stephen R. Burgess *Southwestern Oklahoma State University*
 Tabatha H. Smith *Southwestern Oklahoma State University*

Board 2: The Relationship between Prayer and Rational Thought

Thomas M. Case *Midwestern State University*
 Michael Vandehey *Midwestern State University*

Board 3: Node-Link Mapping and Team Learning: Gender Differences

Gary M. Coyne *Texas Christian University*
 Devereaux J. Branham *Texas Christian University*
 Michael L. Czuchry *Texas Christian University*
 Tiffany L. Sia *Texas Christian University*

Board 4: Influence of Cognitive Vulnerabilities in Victims of Interpersonal Trauma

Lisa Elwood *University of Arkansas at Fayetteville*
 Courtney Smith *University of Arkansas at Fayetteville*
 Heather L. Renfro *University of Arkansas at Fayetteville*
 Tisha L. McDonald *University of Arkansas at Fayetteville*
 Twila S. Owens *University of Arkansas at Fayetteville*
 Anne M. Fisher *University of Arkansas at Fayetteville*
 Rachael M. Motley *University of Arkansas at Fayetteville*
 Nathan L. Williams *University of Arkansas at Fayetteville*

Board 5: Cognitive and Metacognitive Roots of Academic Achievement and College Retention

Matthew C. Johnson *University of Texas at Brownsville*

Board 6: Music Exposure and Cognitive Performance in Elementary and College Students.

Jennifer L. Lake *Texas Lutheran University*
 Rachel A. Price *Texas Lutheran University*

Board 7: An Examination of Executive Functioning in Individuals Accused of Domestic Violence

Tim R. Kockler *Baylor University*
Matthew S. Stanford *Baylor University*

Board 8: Spacing, Recall Confidence, and Actual Recall

Sandra Merryman *Texas State University*

Board 9: Cognitive Vulnerability to Anxiety and Bulimia Nervosa

Nathan L. Williams *University of Arkansas at Fayetteville*
Lisa Elwood *University of Arkansas at Fayetteville*
Rachael M. Motley *University of Arkansas at Fayetteville*
Anne M. Fisher *University of Arkansas at Fayetteville*

Board 10: Dysfunctional Thoughts Versus Cognitive Styles in Anxious and Depressive Symptoms

Courtney Smith *University of Arkansas at Fayetteville*
John M. Reardon *University of Arkansas at Fayetteville*
Lisa Elwood *University of Arkansas at Fayetteville*
Nathan L. Williams *University of Arkansas at Fayetteville*

Board 11: Cognitive Vulnerabilities and the Tripartite Model of Anxiety and Depression

Courtney Smith *University of Arkansas at Fayetteville*
John M. Reardon *University of Arkansas at Fayetteville*
Tisha L. McDonald *University of Arkansas at Fayetteville*
Twila S. Owens *University of Arkansas at Fayetteville*
Nathan L. Williams *University of Arkansas at Fayetteville*

Board 12: Ironic Effects of Intending to Remember

Christian L. Hart *East Central Oklahoma University*

Board 13: Parent-Child Memory for a Staged Event

Beth A. Hentges *University of Houston-Clear Lake*
Debbie L. Grammas *University of Houston-Clear Lake*
Jennifer E. Zapata *University of Houston-Clear Lake*
Christine J. Davis *University of Houston-Clear Lake*
Amy M. Hill *University of Houston-Clear Lake*

Board 14: The Effect of Group Composition on Women's Problem Solving Abilities

Melinda Burgess *Southwestern Oklahoma State University*
Jamie L. LoVecchio *Southwestern Oklahoma State University*

Board 15: Effects of Distractors on Short-Term Memory

Jacqueline L. Cuevas *Midwestern State University*

Board 16: Flashbulb and Event Memory: New Yorkers Tell Their 9/11 Stories

Erynne H. Haugen *Emporia State University*

Board 17: The Effects of Time Pressure on Math Test Scores

Laura A. Hise *Midwestern State University*

Board 18: Do SAT Change Scores Represent Changes in g ?

Thomas R. Coyle *University of Texas at San Antonio*

Board 19: Working Memory Span as a Factor in Attentional Task Performance

Allison R. Hollingsworth *Texas Tech University*
Kimberly J. Scott *Texas Tech University*
Joseph D. Dyson *Texas Tech University*

Board 20: Methodological Properties Examination of 10 Flashbulb Memory Studies

Scott Smith *Texas A&M-Commerce*

Board 21: Relationship Between Working Memory Capacity and Fluency in Information Encoding

Qingwei Wang *Texas A&M-Commerce*
Bernadette M. Gadzella *Texas A&M-Commerce*

Board 22: Rumanitive Biases in Interpretation and Memory

Benito Revilla *Trinity University*
Nancy Liu *Trinity University*
Paula T. Hertel *Trinity University*

Board 23: Effect of Field-of-View on Coordination in Virtual Environments

Maryse R. Amin *University of Texas at San Antonio*

Board 24: Time Intervals Effecting Visual Presentation of the DRM Paradigm

William A. Coker

University of Louisiana-Monroe

Hethe W. Belinge

University of Louisiana-Monroe

Jean M. Low

*University of Louisiana-Monroe***Board 25: Comparison of Three Sources of Individual Differences in Comprehension Ability**

Brenda A. Hannon

*University of Texas at San Antonio***Board 26: Responding to Conflicting verbal and Non-Verbal Referential Cues**

Lawrence B. Lewis

*Texas Lutheran University***Board 27: Angers and Errors of Commission**

Jean M. Low

University of Louisiana-Monroe

Jared S. Cox

University of Louisiana-Monroe

William A. Coker

University of Louisiana-Monroe

Stacey G. Evans

*University of Louisiana-Monroe***Board 28: Aid in Intentional Forgetting**

Kathryn Lee Patterson

Trinity University

Brett A. Munjas

Trinity University

Paula T. Hertel

Trinity University

SWPA Invited Address-*Chaired by Lauren Scharff***Ludy T. Benjamin, Jr.***Texas A&M University***Inez Prosser and the Education of African Americans**

Saturday 9:00 a.m.-9:50 a.m.

Crystal Ballroom

Her life was biography most improbable. Born into a family of eleven children at the end of the nineteenth century in South Central Texas and educated in its "colored" schools, she would teach for eighteen years, and in 1933 would earn a doctorate in psychology, the first by a woman of her race. The following year she would be mourned by family, friends, and students at her burial in San Antonio, Texas. She was 38 years old. Her name was Inez Beverly Prosser.

SWPA Symposium-Teaching Social Psychology

9:00 a.m.-10:30 a.m.

Bluebonnet Room

Chaired by Sherry Berg

Teaching Social Psychology at a Proprietary University

Sherry Berg

DeVry University

PT@CC/Psi Beta Symposium

Chaired by Shirley Clay

**Using Digital Video Conferencing and
Other Web-Based Technology to Enhance Online
Learning**

Carol Barbay

Lamar State College

Irene Doo

Austin Community College

and Joliet Junior College

Saturday 9:00 a.m.-9:50 a.m.

Yellow Rose Room

SWPA General Poster Session

Saturday 9:30 a.m.-10:45 a.m.

Robert Johnson Room

**Board 1: What Do We Know About Sample Size in Structural
Equation Modeling?**

Dennis L. Jackson

University of Windsor

**Board 2: Exploratory Factor Analysis of the Understanding of
Alcoholism Scale**

James A. Gillaspy

University of Central Arkansas

Charity Hallman

Board 3: Scale Validation of a Measure of Domestic Violence

Lindsey J. Olson

Washburn University

Kimberly S. Funk

Washburn University

Nikki D. Boydston

Washburn University

Jennifer E. Ewbank

Washburn University

Dave L. Provorse

Washburn University

Board 4: The Effects of Using an Interpreter on Student Testing Performance

Ramona M. Noland *Sam Houston State University*

Board 5: Comprehending Anaphoric and Cataphoric Pronouns

Shelia M. Kennison *Oklahoma State University*

Elaine C. Fernandez *Oklahoma State University*

Board 6: Usage Preferences for Comparative Adjectives by Native and Foreign Speakers

Shelia M. Kennison *Oklahoma State University*

Jerald M. Bowers *Oklahoma State University*

Board 7: Influencing Sign-up and Show-up Rates in Psychology Experiments

Tabatha H. Smith *Southwestern Oklahoma State University*

Stephen R. Burgess *Southwestern Oklahoma State University*

Board 8: Perceived Intelligence and Attractiveness of Blondes

Ryan L. Gillaspia *Midwestern State University*

Board 9: Unfriendly Experimenter Affects Participants' Opinions of the Researcher, but Not Automatic Mirror Trace Performance

Jason R. Meacham *Emporia State University*

Michelle L. Dawson *Emporia State University*

Cathy A. Grover *Emporia State University*

Board 10: Examination of Life Experiences Impacting Illegal Drug Usage

Jessica G. Padilla *St. Mary's University*

Jennifer L. La Fever *St. Mary's University*

Board 11: Perceived Guilt and Educational Level

Corrie L. Alvarado *St. Edward's University*

Sara B. James *St. Edward's University*

Eric Sosa *St. Edward's University*

Helen D. Just *St. Edward's University*

Board 12: Self-Predictions of Hypnotic Ability: Sex Differences, Confidence Ratings, and Accuracy of Predictions.

Grant Benham *University of Texas-Pan American*

Board 13: The Role of Perception/Action Similarity in Music Performance

Peter Q. Pfordresher *University of Texas at San Antonio*

Board 14: Two Forgiveness Exercises, Anger, and Physical Health

Sheila Fling *Texas State University*

Renee C. Bustos *Texas State University*

Justin Cogswell *Texas State University*

Dustin Hall *Texas State University*

Board 15: Trauma, Religiosity, and drug Use as a Function of Gender

Jennifer L. La Fever *St. Mary's University*

Jessica G. Padilla *St. Mary's University*

Board 16: Psychology and the Mushroom Cloud: Nuclear Testing in the 1950s

Jessica B. Hasty *Texas A&M-College Station*

Jennifer Reck *Texas A&M-College Station*

Ludy T. Benjamin, Jr. *Texas A&M-College Station*

Board 17: Kuhn's Curse: The Marginalization of the Medievals

Curtis O. Pitton *Texas A&M-Commerce*

Paul F. Zelhart *Texas A&M-Commerce*

Tracy B. Henley *Texas A&M-Commerce*

Board 18: Synesthesia and Creativity

Sarah C. Sitton *St. Edward's University*

Edward R. Pierce *St. Edward's University*

SWPA Invited Address-*Chaired by Kenneth A. Weaver*

Diane F. Halpern

Claremont McKenna College

**Work and Family: Stress and Health
The Business Case for Family Friendly Work Policies**

Saturday 10:00 a.m.-10:50 a.m.
Crystal Ballroom

When employers think about cutting costs, the idea of initiating a new policy that would allow employees more decision latitude over their work schedule is rarely considered because it is difficult for most employers to see how such policies would save them money. The more usual response to economic downturns is to reduce the number of hours employees work or the number of employees-business executives think about cuts when considering ways to save money and tend to ignore other possibilities, such as ways to reduce the cost per employee by reducing absences and increasing employee loyalty. The business case for time-flexible work policies may prove to be the best tool we have in changing how we live and work.

SWPA/SCPA Invited Address-*Chaired by Roger Mellgren***Dave Force***Sea World of San Antonio***The Use of the “Least Reinforcing Scenario”
in a Proactive Training Program**Saturday 11:00 a.m.-11:50 a.m.
Crystal Ballroom

The Animal Training Department at Sea World utilizes a powerful training technique called the “Least Reinforcing Stimulus.” This proactive training technique has been in use at all Sea World parks since 1985, and successfully reduces the frequency of aggressive behavior that might otherwise result from the lack of reinforcement due to incorrect or inappropriate behaviors. Once an animal has a sufficient learning history with the LRS, its use following an incorrect response helps to reduce the frustration that might result from the lack of reinforcement

Index

- Ablah, Elizabeth, 53, 55
 Actkinson, Tomme R., 35
 Ahmad, Aneeq, 44, 52, 57
 Allan, Claire K., 62
 Allen, Rachel L., 21
 Alvarado, Corrie L., 79
 Amin, Maryse R., 75
 Anderson, Norman, 19
 Angst, Amanda C., 33
 Apollo, Alexia Rose, 36
 Arellano, Aracely, 43
 Arellano, Denise L., 65
 Armstrong, Philip L., 33
 Arriagra-Ramirez, J.C. Pedro, 41
 Avina, Vanessa, 35, 62
 Backhaus, Autumn L., 29
 Bailey, Scott A., 5, 31, 50
 Ball, Chelsea N., 47
 Barnes, Anna L., 26
 Barnes, Ashley D., 25, 58
 Barnum, Jennifer L., 24
 Barry, Tammy D., 35
 Bartling, Carl, 5, 18, 23, 30
 Batsell, W. Robert, Jr., 20
 Baumgartner, Nicholas A., 25
 Beck, Richard A., 14, 27, 67
 Becker, Carolyn B., 21, 62
 Bedell, Katrina E., 46
 Beeler, Cheryl, 56
 Belinge, Hethe W., 76
 Bell, Jennifer L., 21
 Belmarez, Rachel G., 47
 Beltran, Nova R., 46
 Benham, Grant, 5, 58, 67, 79
 Benjamin, Jr., Ludy T., 18, 77, 80
 Bennett, Carol L., 47
 Bennett, Russell L., 47
 Benton, Mary C., 44
 Berg, Sherry, 67, 77
 Berndt, Andrea E., 63
 Bernstein, Ira, 21, 38, 39
 Bhalla, Mukul, 5, 32, 34, 64
 Bias, Joshua P., 25
 Biedenbarn, Paula J., 60, 64
 Bilhm, Elson M., 5
 Bink, Martin, 40
 Birchfield, Jack, 56
 Blake, Susan B., 67
 Blancher, Adam T., 21
 Bleckley, M. Kathryn, 58
 Bohmann, Amy Dicke, 45, 47
 Bolerjack, Erin M., 44
 Bowden, Rachel, 14
 Bower, Catherine A., 29, 43, 57
 Bowers, Jerald M., 79
 Boydston, Nikki D., 78
 Branham, Devereaux J., 39, 73
 Brinnier, William D., 52
 Brooks, Mindy K., 44
 Brouillard, Pamela, 5, 60, 64
 Brown, Marc D., 54
 Bruce, A. Jerry, 55
 Brunotte, Joshua M., 59
 Bryant, Trelitha R., 28, 54
 Buehler, Nicole, 51, 52
 Burdsal, Charles A., 31, 38, 44, 55
 Burdsal, Jeanne, 4
 Burgess, Melinda, 30, 54, 58, 75
 Burgess, Stephen R., 5, 58, 73, 79
 Burnett, Jason L., 21
 Bustamante, Tamara S., 63
 Bustos, Renee C., 80

Index

- Butler, Kimberly, 43
 Cahal, Carrie H., 39
 Campbell, Cynthia L., 46
 Campbell, Donna, 20
 Canales, Alexandra Z., 46
 Canfield, Rukiya N., 68
 Cano, Richard B., 29, 43
 Cantu, Ethel K., 34
 Carson, Janelle, 68
 Carter, Matt, 40
 Casa de Calvo, Mario P., 48
 Case, Thomas M., 73
 Castoreno, Carl, 57
 Chang, Michelle, 45
 Cheaney, Elizabeth 20
 Chilson, Sheralyn, 51
 Chonko, Larry, 62
 Christensen, Chrisanne, 27, 40
 Christianson, Lauren M., 67, 68
 Ciao, Anna C., 21
 Clark, Alvah E., 52
 Clark, Amanda Jo, 47
 Clark, Brittany, 16, 44
 Cleveland, Michael B., 68
 Cogswell, Justin, 80
 Coker, William A., 76
 Coleman, Scott L., 41
 Compton, William C., 68
 Cook, Karon F., 39
 Copas, Gina, 39, 44
 Corich, Nicole, 36
 Cornell, John E., 39
 Corrigan, Russell P., 29
 Cottingham, B. Jean, 46, 59
 Coulton, Gary F., 5, 47
 Cox, Jared S., 76
 Coyle, Thomas R., 58, 75
 Coyne, Gary M., 73
 Crane, Melissa M., 25
 Crayton, Carol, 33
 Crews, David, 35
 Crosby, Jamey, 61
 Crossett, Sarah A., 47
 Crowley, Donna A., 60
 Croyle, Kristin L., 30, 54, 57, 60
 Cuevas, Jacqueline L., 26, 46, 48, 75
 Cusato, Brian, 34, 42
 Cusato, Melissa Burns, 42, 66
 Czuchry, Michael L., 39, 73
 Czyzewska, Maria, 36
 Dailey, Susan, 40
 Davidson, Margaret, 51
 Davis, Carolyn S., 67, 68
 Davis, Christine J., 74
 Davis, John M., 2, 4, 29, 32, 42, 43, 57, 65
 Davis, Leah, 34
 Davis, Shane, 43
 Davis, Stephen, 2, 50
 Dawson, Michelle L., 41, 79
 Denis, Meroudjie, 71
 Desforges, Donna M., 59
 Dianovich, Jeannette E., 36
 DiFiore, Jacqueline P., 24
 Dilks, Lawrence S., 27, 67, 68, 69
 Domjan, Michael, 35
 Donovan, Kathleen M., 26, 32, 55
 Dougherty, Donald M., 32, 35, 50
 Dougherty, Thomas, 5, 56
 Douglas, Deanna K., 44
 Droege, Tyler C., 39

Index

- Dudley, George, 21, 28, 54, 62
 Duffy, Lauren Squyres, 20
 Duran, Stephanie G., 48
 Durso, Francis T., 28
 Dyson, Joseph D., 75
 Eisenberg, Ann R., 5
 Elliott, Marcus P., 30
 Elwood, Lisa, 21, 64, 73, 74
 Enami, Takashi, 44
 Evans, Stacey G., 76
 Evans, Terri L., 47
 Ewbank, Jennifer E., 78
 Fairchild, Jennifer, 29
 Falkenberg, Rebecca L., 32
 Farris, Emily A., 26
 Featherston, Charlotte A., 36
 Fenter, Jennifer, 36
 Fernandez, Elaine C., 79
 Fesperman, Theresa H., 62
 Festa, Daniel K., 55, 56
 Fisher, Anne M., 21, 73, 74
 Fisher-Smith, Amy M., 71
 Flannagan, Dorothy A., 63, 68
 Fling, Sheila, 80
 Flynn, Steven B., 53
 Foster, Patricia, 30
 Franks, Kerri K., 40
 Fregia, Kara L., 60, 64
 French, Laurence A., 5, 34
 Fritz, Noelle M., 34
 Froese, Arnold D., 5, 64,
 Frohardt, Russell J., 20
 Frost, James, 33
 Funk, Kimberly S., 78
 Gadzella, Bernadette M., 31, 46, 75
 Garcia, Christina, 60, 64
 Garcia, Stephanie M., 69
 Garcia-Lopez, Stella D., 5, 32, 55
 Garland, Beth H., 35
 Garrett, Stephanie K., 60, 64
 Garza, Gilbert J., 71
 Garza, Laura Cruz, 58
 Gee, Damon, 47
 Gervais, Allison, 61, 67
 Gibbons, Kelly, 34
 Gibson, Jennifer L., 23
 Gillaspia, Ryan L., 79
 Gillaspy, James A., 78,
 Gilmore, Candace N., 30
 Ginsburg, Harvey J., 36
 Girgis, Ashley J., 62
 Glaser, Daniel S., 31, 40
 Gleason, Stephanie, 42
 Golding, Troy E., 68
 Goldsmith, Michael R., 68
 Gomez, Jerry, 30, 54, 57, 60
 Goodale, Grant S., 55
 Goodson, Shannon L., 28
 Goodwyn, Mary Ann, 46, 60
 Gordon, Stephany, 45
 Grammas, Debbie L., 74
 Green, Raymond J., 5, 33, 45
 Greer, Sarah E., 54
 Griggs, Emily N., 47
 Grissin, Tamera, 43
 Grover, Cathy A., 4, 25, 29, 41, 79
 Guarraci, Fay, A., 51
 Gutierrez, Belinda, 39, 40
 Gwathmey, Melissa G., 31
 Hadsell, Ashley E., 36

Index

- Halcomb, Charles, G., 38
 Hale, Carrie, 14
 Hall, Dustin, 80
 Hallman, Charity, 78
 Hammer, Tonya R., 21
 Hannon, Brenda A., 5, 76
 Hargrove, Anne, 59
 Harris, Richard J., 5
 Harke, Rachel M., 26
 Harland, Richard D., 5, 29, 41
 Harman, Marsha J., 55
 Harrell, Ernest H., 40
 Harrington, Rick, 48, 63
 Hart, Christian L., 5, 74
 Hartlaub, Mark, 24, 60, 64
 Hasty, Jessica B., 80
 Haugen, Erynne H., 75
 Havens, Stephany M., 28
 Hebl, Michelle, 28
 Heflin, Suzanne R., 32
 Hemberger, Laura J., 21
 Hemenway, Elizabeth A., 30
 Henley, Tracy B., 53, 58, 80
 Hennig, Charles, 4, 28, 70
 Henseler, Sarah E., 36, 63
 Hentges, Beth A., 46, 74
 Hernandez, Bernardino, 58
 Hertel, Paula T., 75, 76
 Higa, Jennifer, 20
 Hightower, David, 41
 Hill, Amy M., 74
 Hill, Jason H., 28
 Hise, Laura A., 75
 Hodge, Gordon, 37
 Hoelscher, Keith, 22
 Hollingsworth, Allison R., 75
 Hom, Jr., Harry L., 45
 Hopkins, William D., 52
 Howard, Jeannie L., 56
 Hughes, Tommie, 23
 Huichan-Olivares, Francisco, 41
 Hutchens, Scott A., 29, 40
 Hynan, Linda, 5, 33
 Idol, Amie M., 59
 Jackson, Dianna, 15
 Jackson, Dennis L., 4, 39, 78
 Jackson, Glenda C., 41
 Jackson, Karen A., 5, 22
 Jagar, Ashley, 50
 James, Rochelle, 17
 James, Sara B., 79
 James-Aldridge, Valerie G., 41
 Jessee, Allison C., 21
 Johnson, Janet, 41
 Johnson, Judith Lynn, 24
 Johnson, Matthew C., 73
 Johnson, Quinessa, 60
 Johnson, Scott W., 66
 Jorgenson, Dale O., 54
 Jovel, Marcia M., 69
 Juarez-Maldonado, C. Edith, 41
 Just, Helen D., 32, 36, 79
 Karcher, Megan, 61
 Karash, Al, 12
 Kardas, Edward P., 4, 5, 9, 25, 40, 56, 70
 Kasner, Rebecca A., 21
 Kaylor, Carla, 21
 Kearney, Lisa K., 60
 Kelley, Erin, 67
 Kelley, Sheri Y., 46
 Kelly, William E., 5

Index

- Kennison, Shelia M., 5, 31, 58, 79
 Key, Kristal, 59
 Kirk, Edythe E., 26
 Kirk, Roger, E., i, 43
 Kirkpatrick, Kelly J., 48
 Kirshbaum, Lauren M., 23, 50
 Knowles, Laura R., 63
 Kockler, Tim R., 74
 Kopp, James L., 65
 Kramer, Tricia, 55
 Kranz, Peter L., 52, 61
 Krause, Mark A., 5, 20
 Lacy, Catherine B., 36
 La Fever, Jennifer L., 79, 80
 Lake, Jennifer L., 73
 Lambert, Paul L., 40
 Laminack, Trey, 14
 Lammers, Bill J., 64
 Lamothe-Francois, Marie B., 25
 Landrum, William W., 68
 Lara, Dalila B., 57
 Lawson, David, 25, 58
 LeBeck, Michelle, 17
 Leftwich, Michael J.T., 29
 Leverenz, Erin L., 36
 Leverett, Danelle, 14, 27
 Lewis, Lawrence B., 5, 25, 76
 Lewis, Veronica E., 59, 60
 Ligocki, Michael K., 63
 Lindoerfer, Joanne S., 22, 66
 Lindquist, Stephanie L., 44
 Liu, Nancy, 75
 Loffredo, Donald A., 22, 48, 63
 Long, Angela A., 68
 Long, Chavonne A., 58
 Looney, Adam, 27, 61
 Lopez, Myriam, 58
 Loufus, Katherine A., 71
 LoVecchio, Jamie L., 75
 Low, Jean M., 23, 46, 68, 76
 Loya, Mirna F., 59
 Lucas, Don R., 21
 Lucas, Sue W., 25
 Lunt, Mica A., 24
 Lyman-Henley, Lani P., 53
 Lynch, Molly E., 25, 30
 Madkins, Jeanette P., 58
 Magaloni, Ignacio R., 21
 Mangold, Deborah, 69
 Marceaux, Janice C., 23, 30, 69
 Marsh, Dawn M., 32, 35
 Martin, Boone, 14
 Martin, James H., 22, 24
 Martinez, Angel M., 26
 Masten, William G., 31
 Mata, Crystal N., 14, 54
 Mather, Robert D., 48
 Mathias, Charles W., 32, 35, 55
 Matthews, Camelia, 50, 55
 Matthews, R. Nicolle, 35
 Matzenbacher, Dena L., 27, 67, 68
 Mayeaux, Brooke D., 23, 30, 69
 McCarthy, Maureen, 43
 McCown, William G., 23, 31, 69
 McDaniel, Max J., 45
 McDonald, Tisha L., 53, 73, 74
 McGahan, Erin L., 68
 McGahan, Joe, 21, 53
 McGregor, Loretta N., 3, 40, 47
 McKenna, Ralph J., 5, 29

Index

- McLeod, Nathan D., 52
 McNaughton-Cassill, Mary Ellen, 5, 25, 30, 68
 McPherson, Christy L., 20
 Meacham, Jason R., 79
 Meier, Jo A., 5, 25, 37, 63
 Mellgren, Roger L., 41, 82
 Men, Jhenna S., 46
 Merchant, Tazim S., 63
 Merryman, Sandra, 5, 74
 Milkavich, Amy K., 63
 Miller, Mary F., 36
 Miller, Sarah J., 23, 30
 Moeller, Heather C., 60, 64
 Montgomery, Dee H., 22, 24
 Montgomery, Robert L., 22, 24
 Moore, Patrick W., 37
 Morrone, Angela M., 63
 Mosack, Victoria A., 31, 44
 Motley, Rachael M., 73, 74
 Mowrer, Robert, 5, 31, 58
 Munjas, Brett A., 76
 Murillo, Krystle, 35
 Murphy, Christine T., 68
 Murphy, Michael D., 5, 59
 Nail, Paul R., 5, 26, 46
 Neal, Kurtis R., 28, 55
 Neighbors, Bryan, 16, 17, 23, 36
 Nelson, Amelia L., 26
 Nix, Achlie N., 48
 Noland, Ramona M., 79
 O'Loughlin-Brooks, Jennifer, 72
 Oem, Deborah, 55
 Ogletree, Shirley M., 59
 Oldenkamp, Jeffrey L., 54
 Oliver, Robert C., 54
 Olson, Laura M., 16, 18, 29
 Olson, Lindsey J., 78
 Onyejiaka, Ugochi U., 18, 54
 Ortega-Saavedra, M. Guadalupe, 41
 Ortiz, Courtnie D., 47
 Ouellette, Jason K., 46
 Owen, Patricia, 40
 Owens, Twila S., 47, 73, 47
 Padilla, Jessica G., 79, 80
 Pallares, Carla, 44
 Parker, Andrew J., 71
 Parker, Kristen, 27, 67
 Parsons, Chad, 47
 Pate, William E., 72
 Pathak, Lalita, 61
 Patterson, Kathryn Lee, 76
 Peoples, Jaime N., 46
 Peques, Lindsay, 33
 Peralez, Melanie A., 30, 54, 57, 60
 Perez, Aaron M., 28
 Perez, Allison, 22
 Perez, Catherine A., 63
 Perez, Iliana M., 30, 54, 57, 60
 Perkins, Scott, 14, 61
 Pfordresher, Peter Q., 80
 Phillips, Courtney L., 26
 Pierce, Alicia, 57
 Pierce, Amber, 16
 Pierce, Edward R., 80
 Pillow, David R., 63, 68
 Pinalez, Monica B., 30, 54, 57, 60
 Pittenger, John B., 53
 Pitton, Curtis O., 80
 Pollard, Meghan, 45
 Porter, Benjamin A., 58
 Prentiss, Jared, 61

Index

- Prestrude, A.M., 62
 Pretzel, Jason D., 68
 Price, Catherine H., 23
 Price, Rachel A., 73
 Provorse, Dave L., 5, 59, 78
 Pruneau, Genevieve M. C., 15, 23
 Purdy, Jesse E., 2, 20, 37, 51, 65
 Rafferty, James M., 47
 Ragha-Cooper, Jigna V., 63
 Ramirez, Ricardo A., 58
 Ramsey, Mary, 35
 Ranney, Sandra L., 44
 Realini, Anthony D., 53
 Reardon, John M., 47, 74
 Reck, Jennifer, 80
 Reed, Joseph A., 44
 Reich, Darcy A., 23, 48
 Remkus, Margaret, 52
 Renfroe, Heather L., 64, 73
 Revilla, Benito, 75
 Riggs, Abigail L., 17
 Riggs, Billy Joe, 14
 Riggs, David, 27
 Riley, Shannon K., 44
 Ritter, Gerald W., 61
 Rivas, Criselda G., 68
 Rivera, Luis O., 58
 Rivera, Saori, 25
 Robertson, Bre, 61
 Rodriguez, Sandra, 22
 Rogers, Kimberly, 5, 68
 Rogers, Leslie J., 22
 Rogers, William S., 5, 56
 Roman Martinez, Mirella, 30, 54, 57, 60
 Roper, Karen L., 5, 20
 Ryburn, Jennifer D., 56
 Sanchez, Diana L., 22,
 Sandall, Jana C., 45
 Saville, Bryan K., 30, 46, 48
 Schapiro, Steven J., 51, 52
 Scharff, Lauren, 5, 54, 57, 66, 77
 Schell, Kraig, 5, 28, 55
 Schmidt, Carolyn, 44
 Schnelker, Joanna, 20
 Schwartz, Lauren H., 26
 Scott, Carl W., 45
 Scott, Johnathan W., 41
 Scott, Kimberly J., 75
 Scroggins, Beth C., 40
 Scroggins, Bethany, 67
 Seidel, Steven D., 60, 64
 Sharpe, John, 20
 Sherrill, Rochelle L., 63
 Shrader, Greg L., 71
 Sia, Tiffany L., 39, 73
 Singg, Sangeeta, 22, 54
 Sitton, Sarah C., 80
 Sloan, Taylore A., 17, 54
 Smith, Alexis N., 28
 Smith, Cara L., 24
 Smith, Courtney, 73, 74
 Smith, Lisa, 21
 Smith, Randolph A., 4
 Smith, Scott, 75
 Smith, Tabatha H., 58, 73, 79
 Smith, Valerie, 72
 Snow, Lesley P., 30
 Sosa, Eric, 79
 Sparks, Christina M., 69

Index

- Speed, Jaqulyn, 45
 Spence, Karen E., 63, 68
 Spriggs, Martha L., 21
 Stacks, James R., 31, 46
 Stanford, Matthew S., 74
 Stephens, Rebecca C., 31
 Sternberg, Robert J., 42, 56
 Stewart, Lori A., 45
 Stiles, Brandy L., 59
 Stimmel, D. Theron, 33
 Stinson, Amanda M., 32
 Stoddard, Melissa, 61
 Strenth, Cristopher T., 45
 Strickland, Reshaunda, 43
 Sullivan, Christopher, 61
 Sutcliffe, Shana J., 37
 Sutton, Matt V., 36
 Sween, Stephanie A., 47
 Talmage, Bridget M., 56
 Tamez, Jeannine P., 26
 Tani, Sophia, 35
 Tanner, John F., 62
 Taylor, Reyda L., 34
 Taylor, Ronald D., 5, 62
 Teal, Cayla R., 31, 39
 Thayer-Coleman, Leslie L., 63
 Thomas, Mark D., 58
 Thompson, Bruce, 19
 Thompson, Cassie, 57
 Thompson, Shelby C., 44
 Thompson, Virginia K., 46
 Torres, L. Cristy, 52
 Tortorice, Maria, 32
 Townsend, Jill M., 66
 Towsley, Jacqi S., 46
 Trager, Jenni M., 40
 Trotter, David, 23, 50
 Truhn, Patricia, 61
 Truxillo, Nicole A., 57
 Turner, Carolyn S., 31
 Turner, G. Marc, 59
 Valdez, Michelle M., 60, 64
 Vandehey, Michael, 73
 van der Zee, Karen I., 55
 Van Leeuwen, Marilyn D., 20
 Vaughn-Garcia, Amber, 15
 Venkataraman, Dipali, 37
 Vera, Elizabeth, 16, 23
 Vickers, Victoria, 59
 Vieira, Ana C., 59
 Volland Bette L., 57
 Wade, Candice, 36
 Wade, Jonathan, 67
 Wallace, Harry M., 45
 Wallace, Walonda S., 68
 Walters, Jill, 25
 Wang, Qingwei, 75
 Ward, Todd A., 46, 54
 Watkins, Abby, 29
 Watson, Sheree, 66
 Weaver, Kenneth A., 4, 19, 24, 29,
 32, 69, 70, 81
 Webster, Meredith, 40
 Weissenburger, David, 61
 Wells, Anthony O., 68
 Wetta-Hall, Ruth, 53, 55
 White, Leslie, 16
 White, Linda, 72
 White, Robin E., 25, 48
 Wiebers, Todd, 39, 57

Index

Wight, Randall D., 4, 34, 47, 50
Wiley, Elizabeth S., 35, 64
Willeford, Jodie L., 68
Williams, Nathan L., 5, 21, 25, 47, 63, 64, 73, 74
Williams, Trisha, 67
Williamson, J. David, 21
Wilson, Christopher, 55
Wilson, Deborah J., 40
Wilson, Jamie, 22
Winkle, Debi K., 41
Wolfrom, Mindy, 34
Womack, Paula J., 23
Wood, Jaime, 46
Wood, Virginia V., 34
Yancey, George B., 27
Yarborough, Brianna L., 45
Younger, Kathleen A., 59
Zapata, Jennifer E., 74
Zelhart, Paul F., 80
Ziebro, Monique, 59
Ziegler, Rand, 26
Ziemer, Heidi E., 3, 18, 44
Zinn, Tracy E., 21, 22, 34,
Zwahr-Castro, Jennifer R., 31

2005 SWPA Convention

Peabody Hotel: Memphis, TN

March 24 - 26, 2005

